

**BUILD YOUR OWN®**

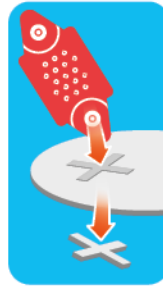

Use the Removal Tool to push out the smaller pieces of card.



Pre-crease all the folds before you build each step unless otherwise stated.



If you get stuck, try looking at the next few steps to help you out.



Don't rush! Make yourself a cuppa and take your time while building.

Need some help?  
Scan here for video instructions



BuildYourOwnKits.com

These are the sheets you will need for this stage

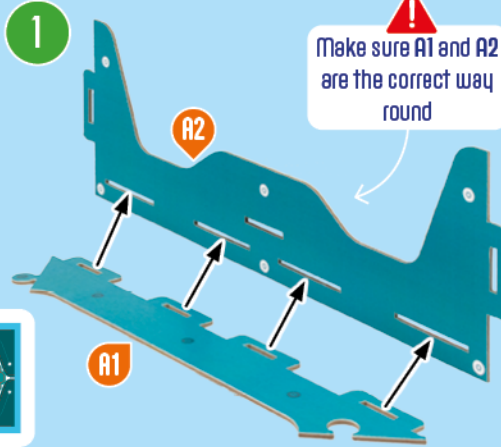
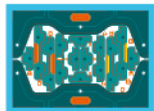

Make sure A1 and A2 are the correct way round

Boxes with WHITE backgrounds show how it should look

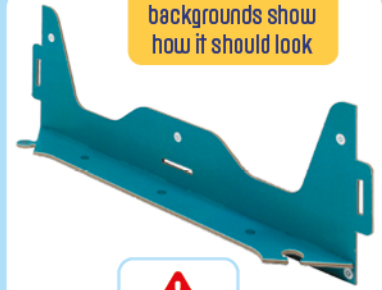

**NOW TURN THE PART AROUND**

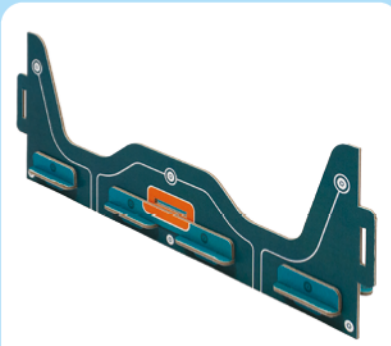
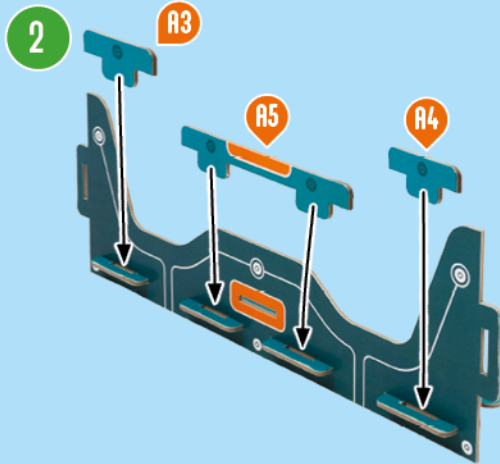

Put to one side

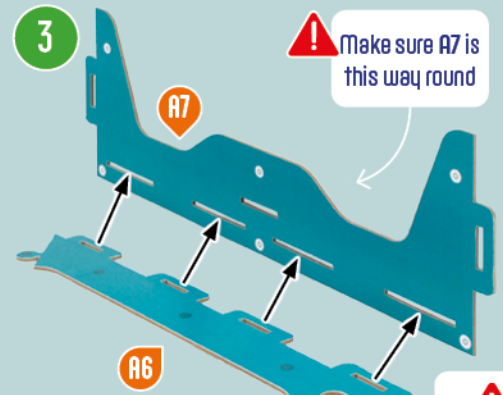

Make sure A7 is this way round

**NOW TURN THE PART AROUND**

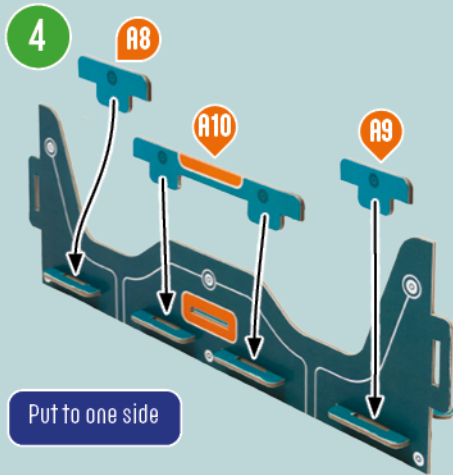

Put to one side

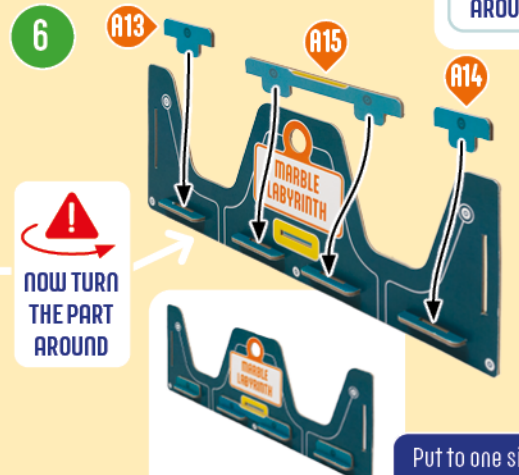
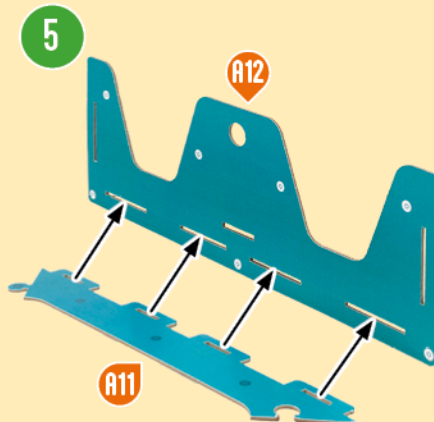

**NOW TURN THE PART AROUND**

Put to one side

7

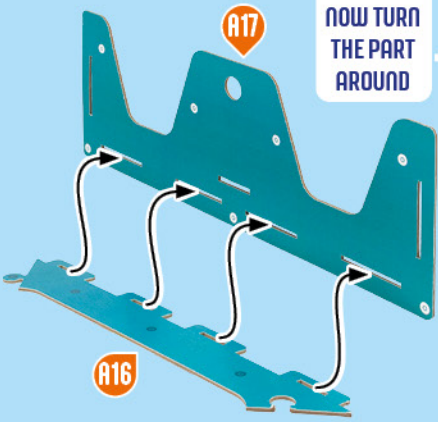

NOW TURN  
THE PART  
AROUND

8

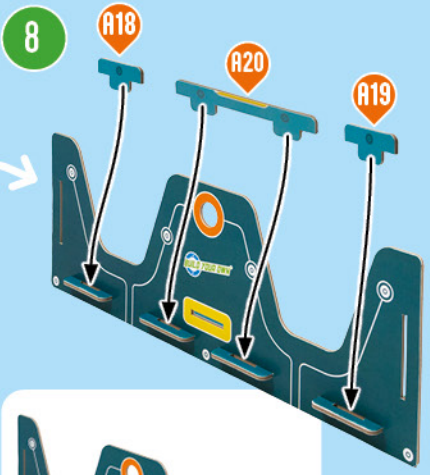

Put to one side

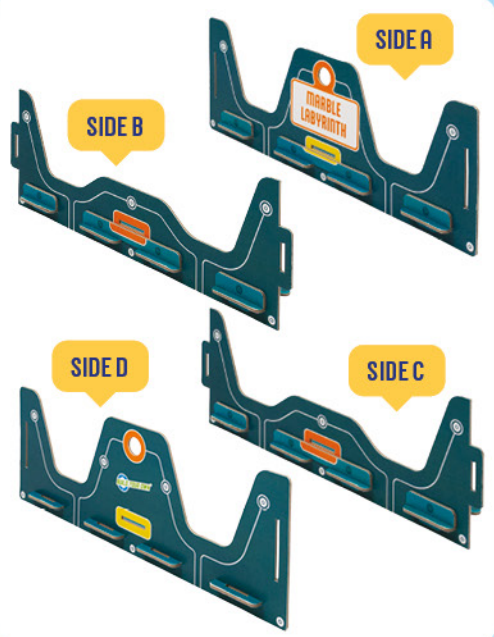

9

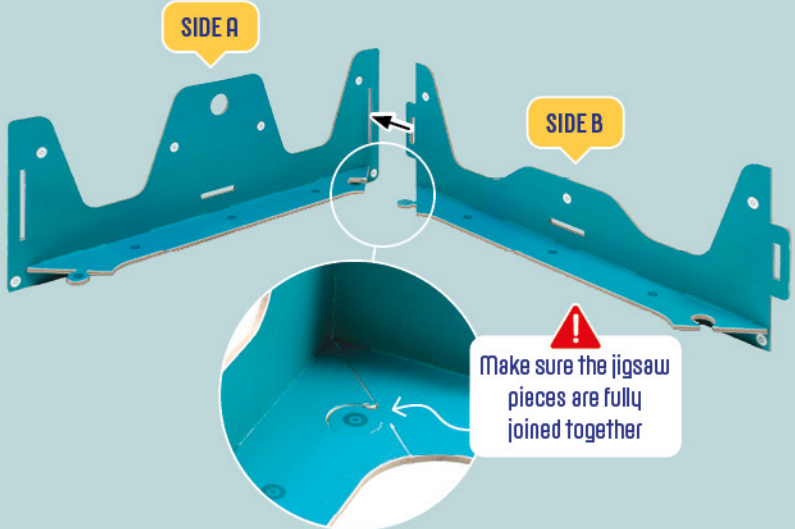

Make sure the jigsaw  
pieces are fully  
joined together

10

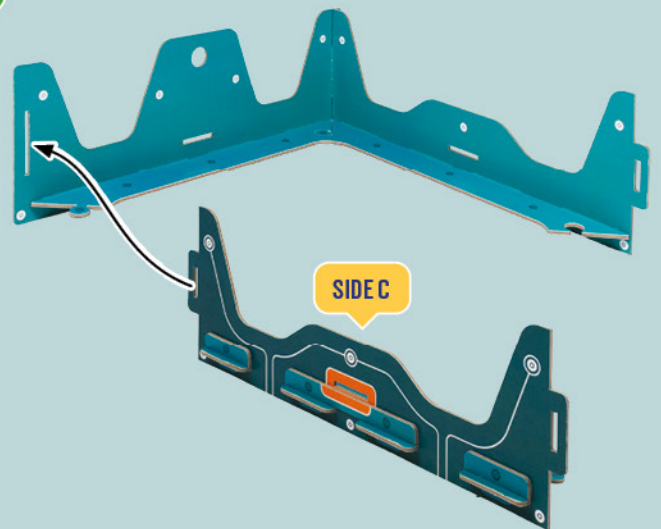

11

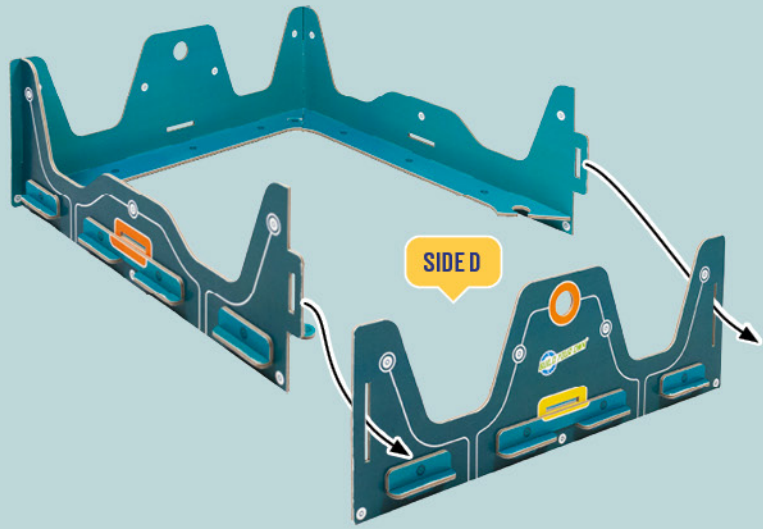

12

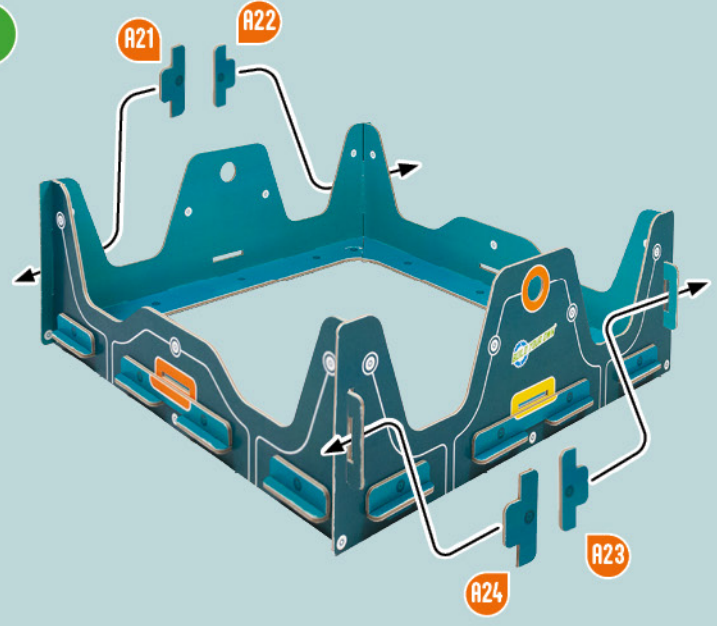

This is the  
sheet you will  
need for this  
stage



13

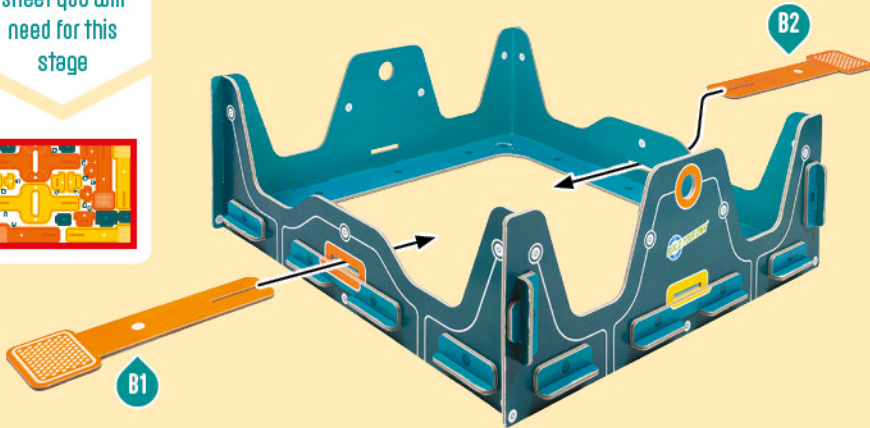

Need some help?  
Scan here for video  
instructions



14

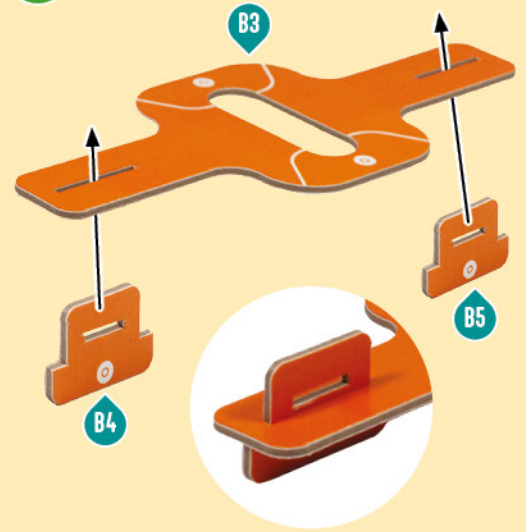

15

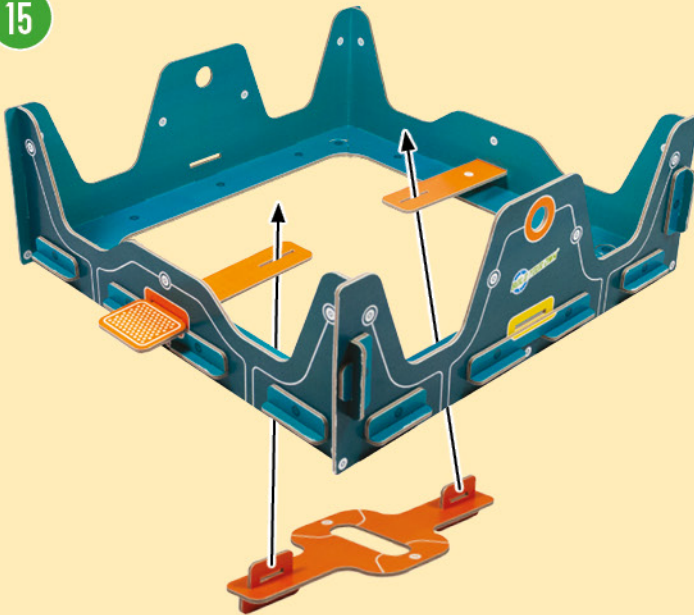

16

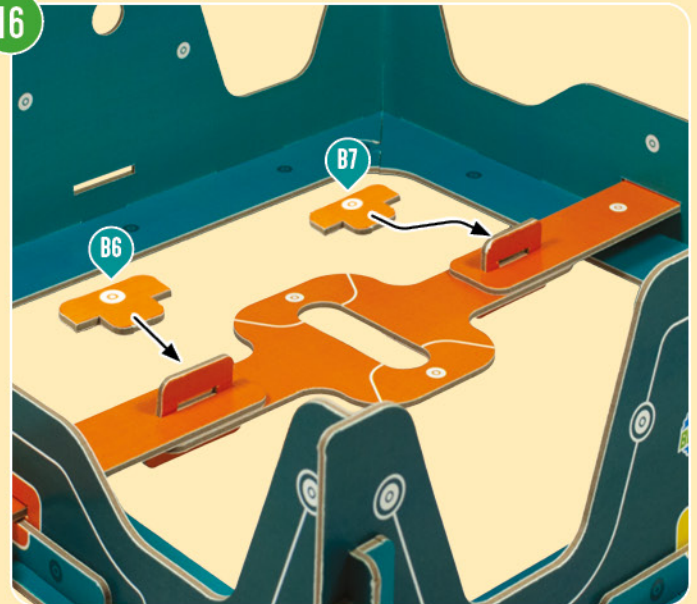

17

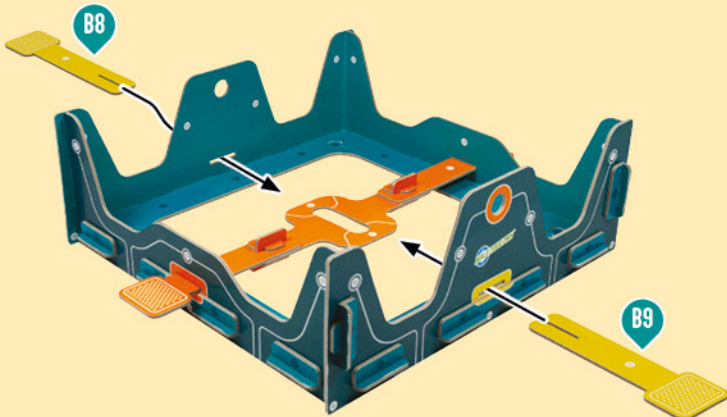

18

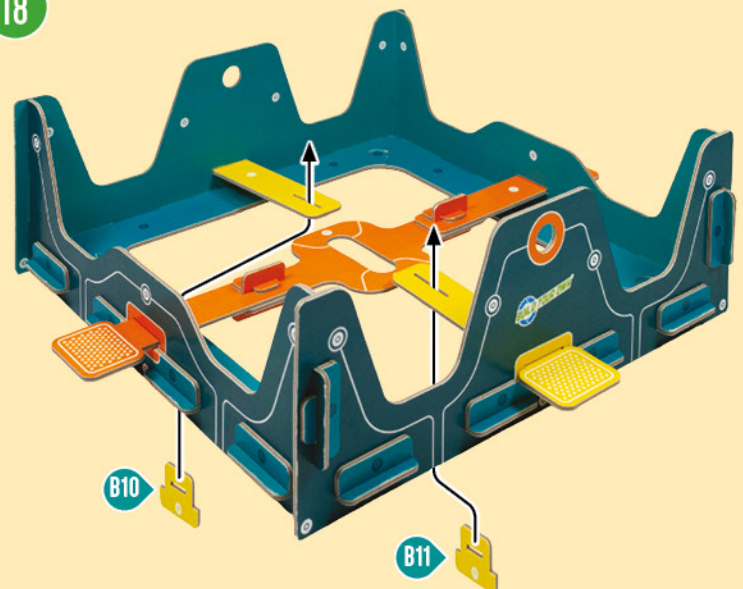

19

B12

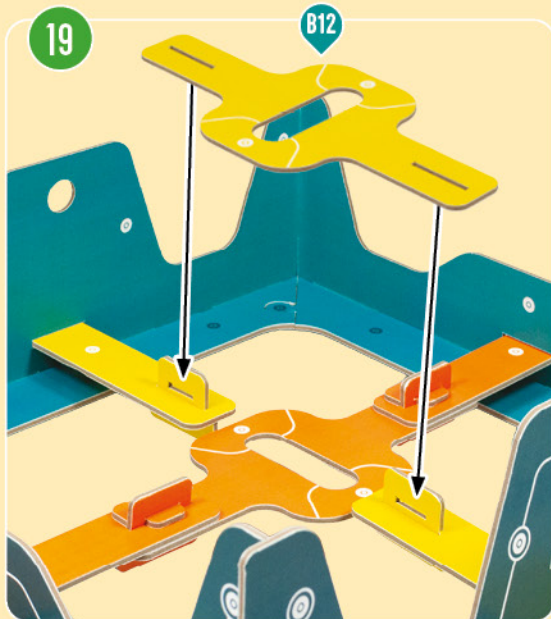

20

B13

B14

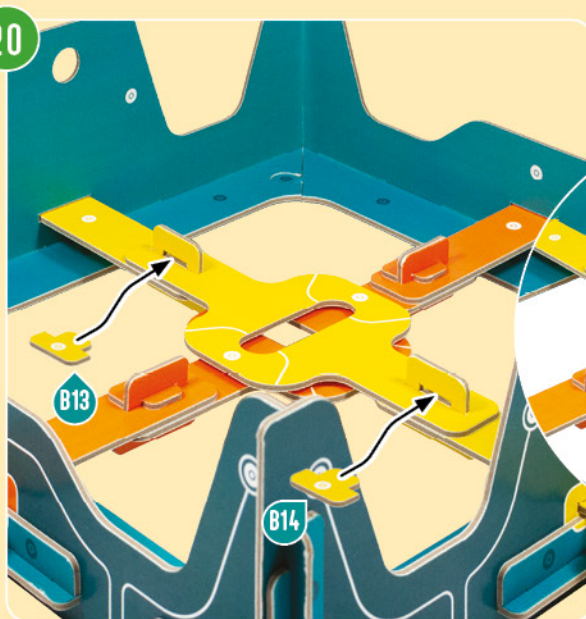

Put to one side

These are the sheets you will need for this stage

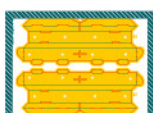

21

C1

C3

C2

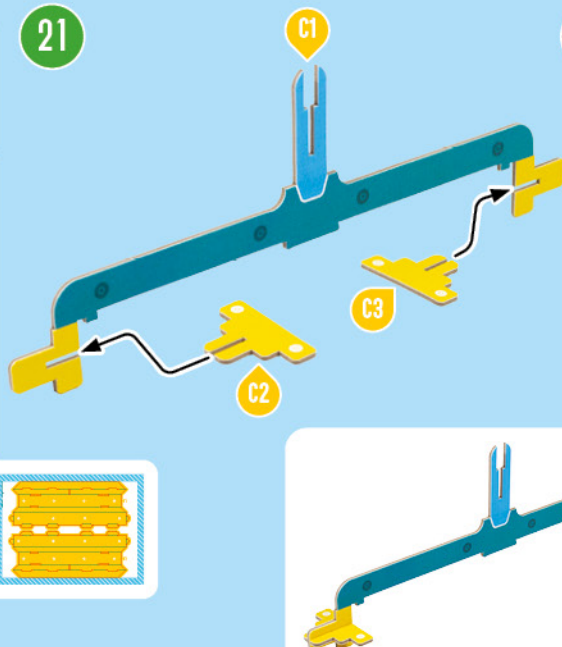

22



Don't forget to pre-crease all the folds!

C4

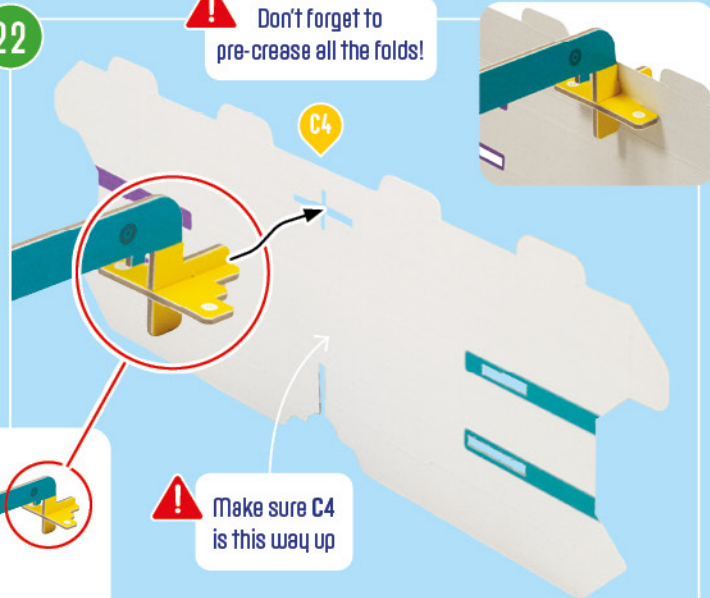

Make sure C4 is this way up

23

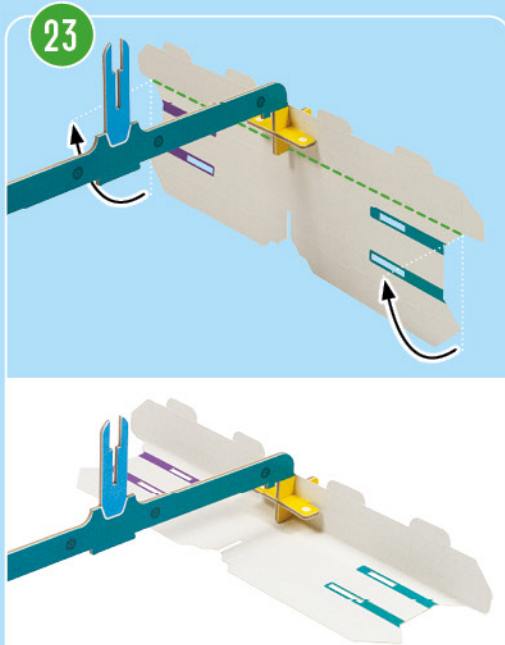

24

C5

25

C6

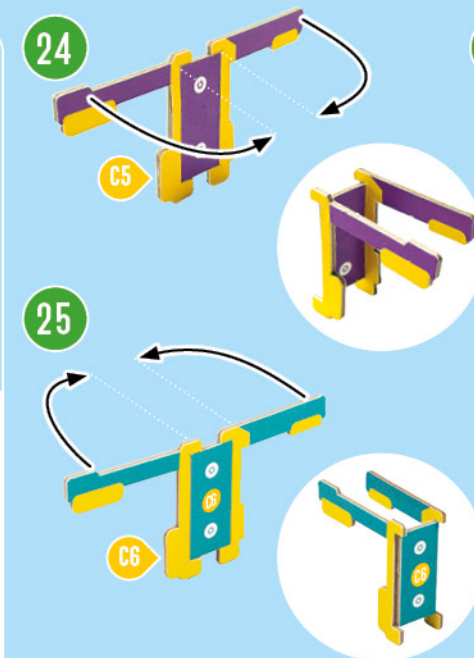

26

C5

C6

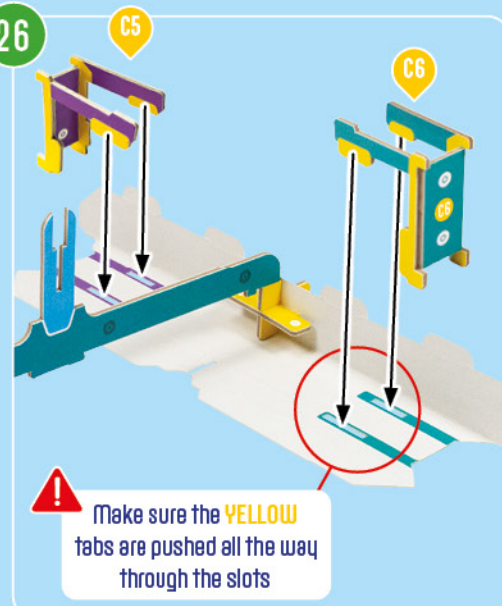

Make sure the **YELLOW** tabs are pushed all the way through the slots

27

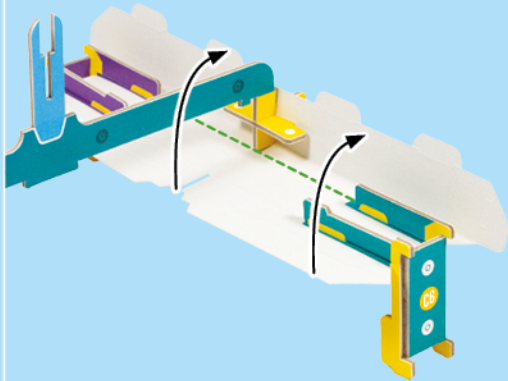

Need some help?  
Scan here for video  
instructions



28

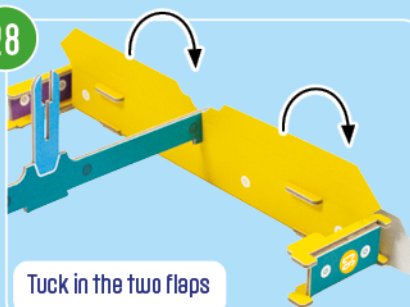

Tuck in the two flaps

29

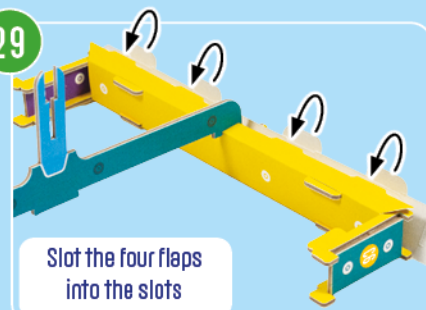

Slot the four flaps  
into the slots



NOW TURN  
THE PART  
AROUND



This is how it  
should look

30

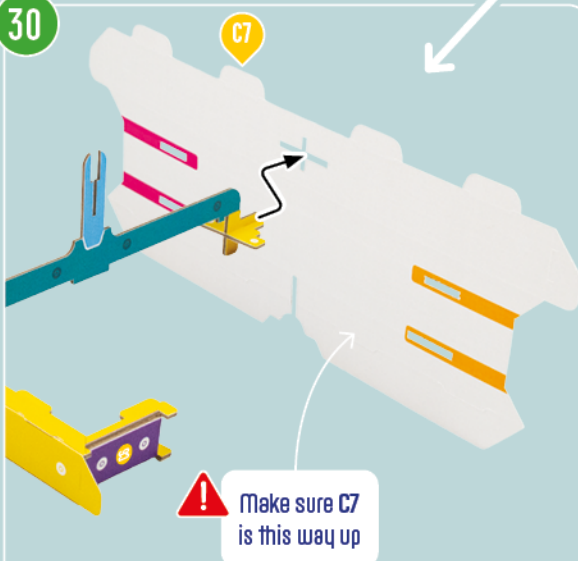

Make sure C7  
is this way up

31

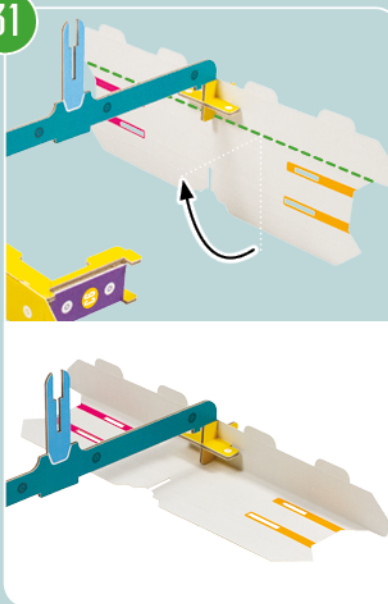

32

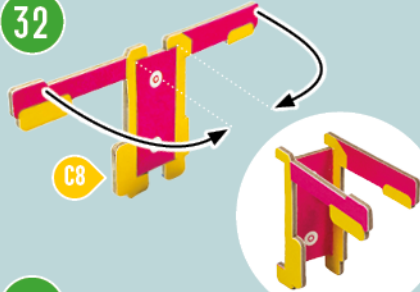

33

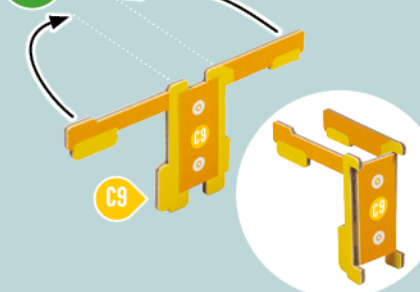

34

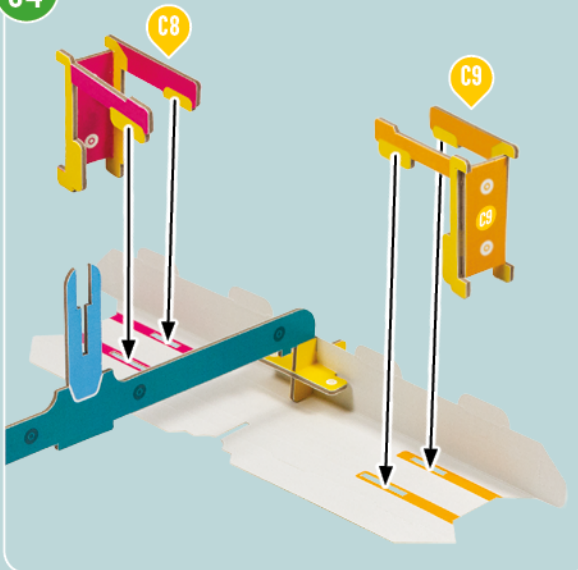

35

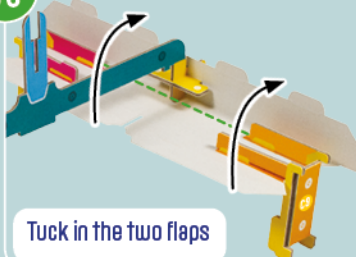

Tuck in the two flaps

36

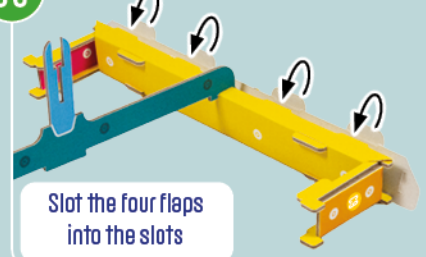

Slot the four flaps  
into the slots

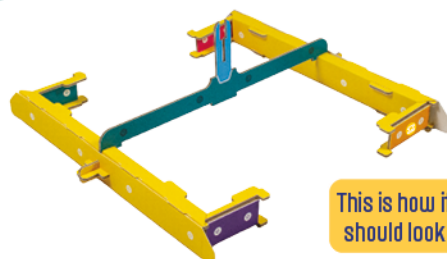

This is how it  
should look

37

C10



Make sure C10  
is this way up

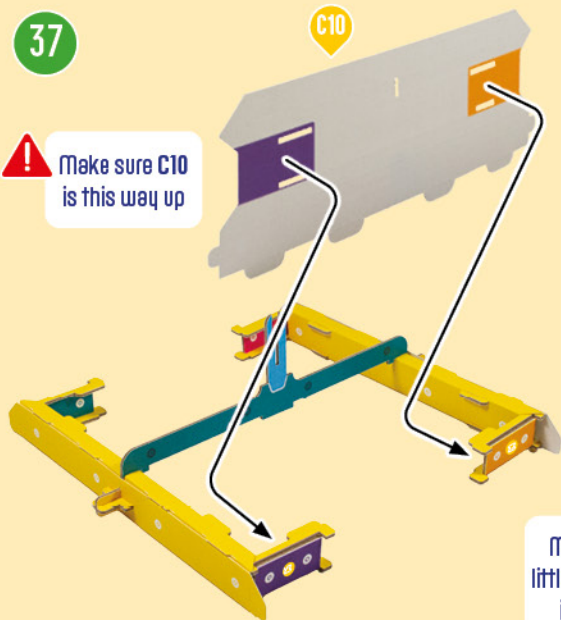

38

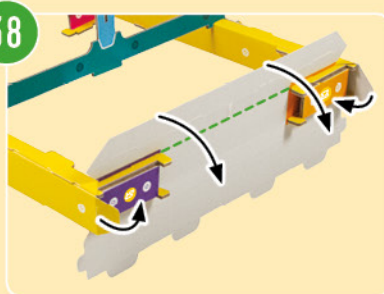

39

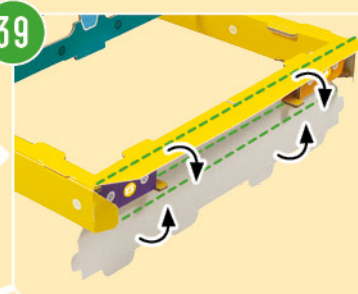

40

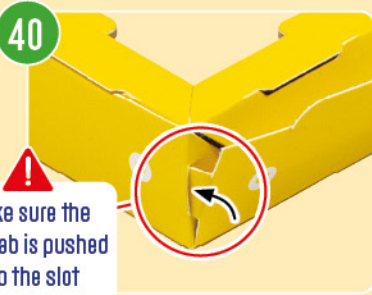

Make sure the  
little tab is pushed  
into the slot

41



Need some help?  
Scan here for video  
instructions



42



Make sure C11  
is this way up

C11

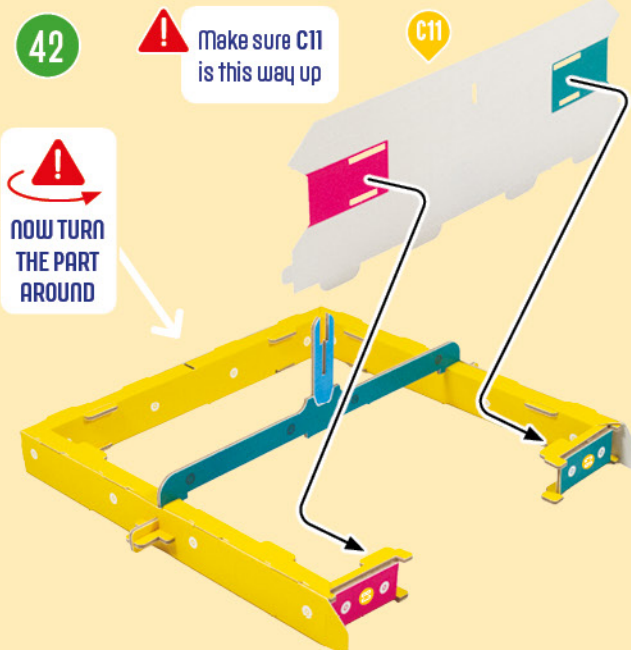

NOW TURN  
THE PART  
AROUND

43

Fold over and tab  
together as shown  
previously

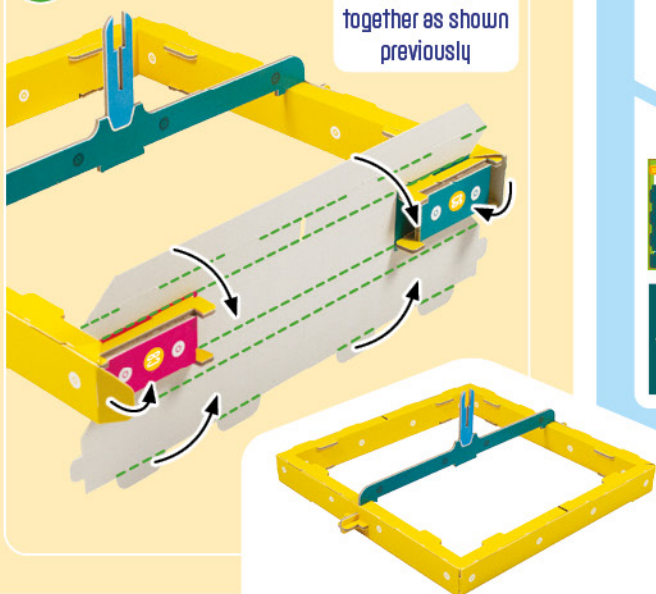

These are the  
sheets you  
will need for  
this stage



44

C12

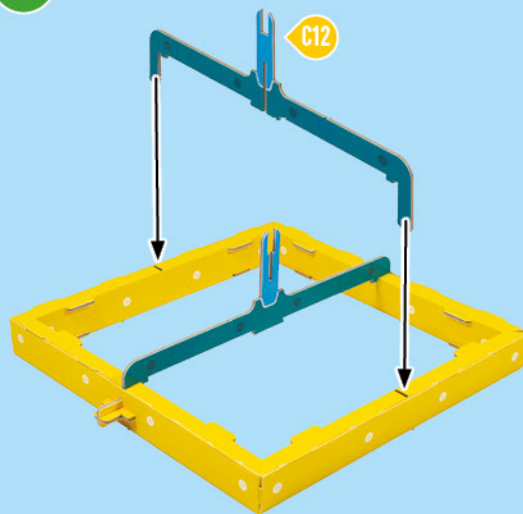

45

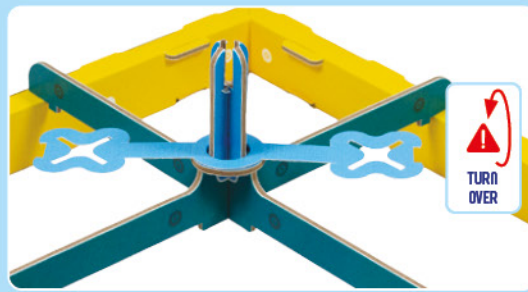
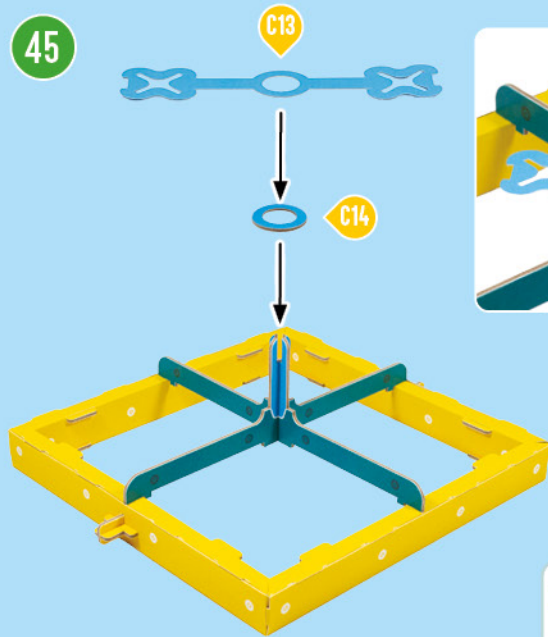

46

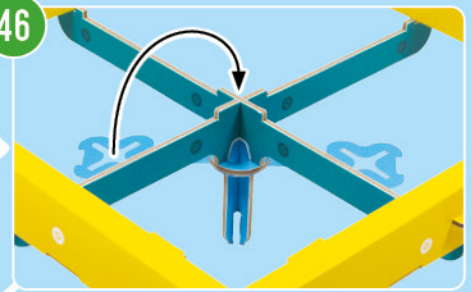

47

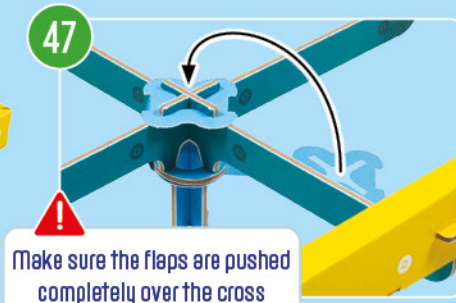

Make sure the flaps are pushed completely over the cross



These are the sheets you will need for this stage

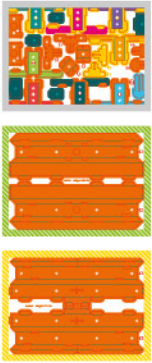

48

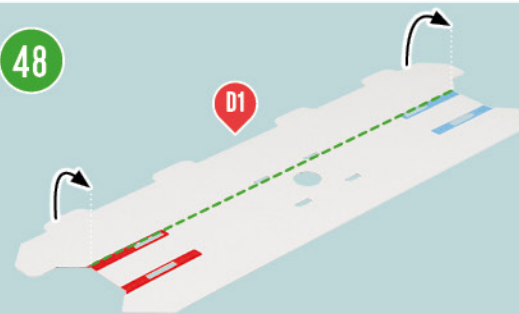

49

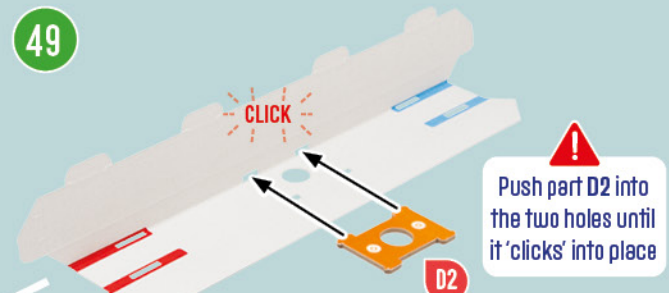

Push part D2 into the two holes until it 'clicks' into place

50

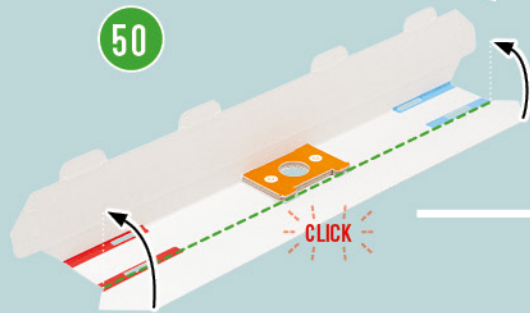

! Tabs should protrude like this

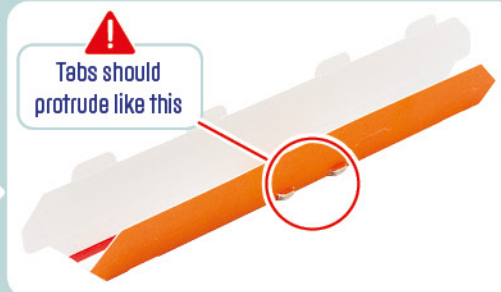

51

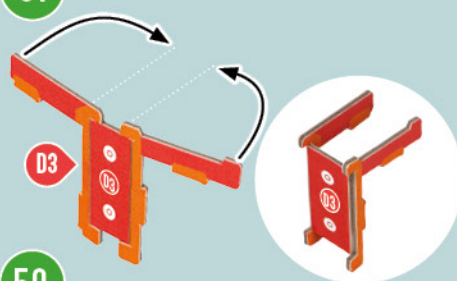

52

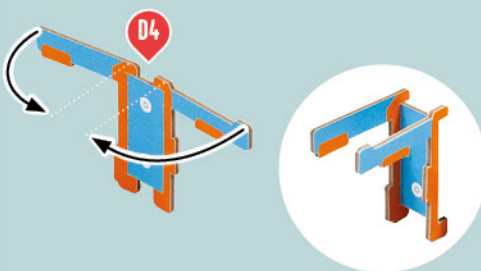

53

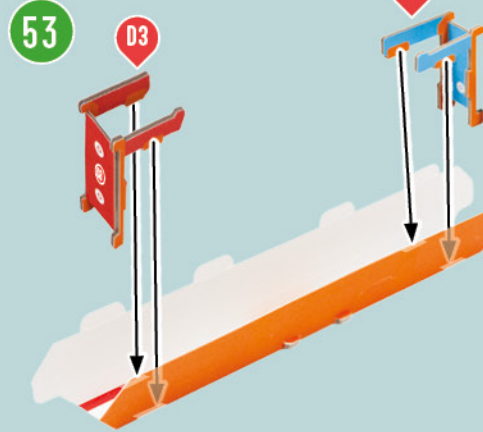

54

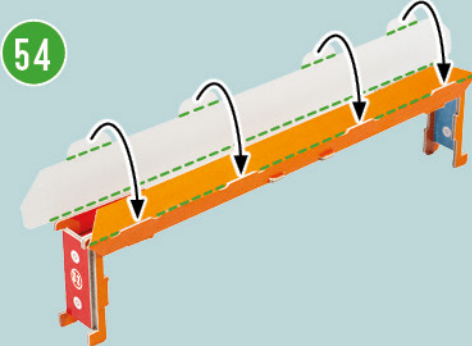

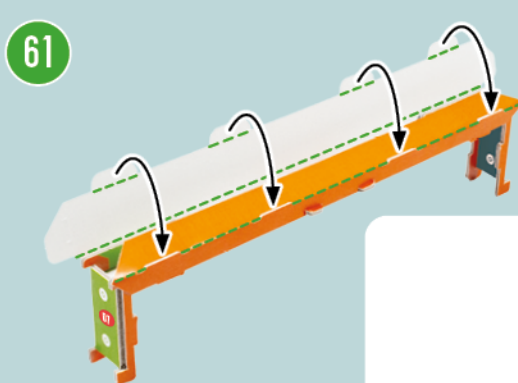
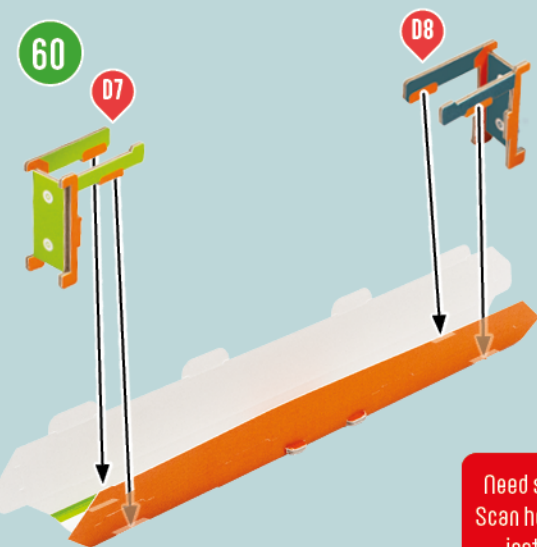
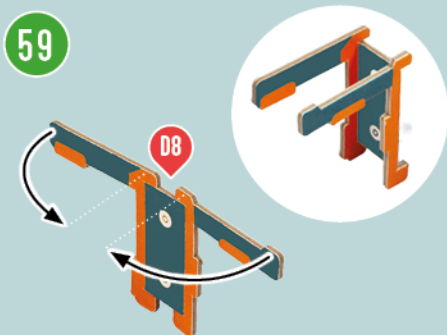
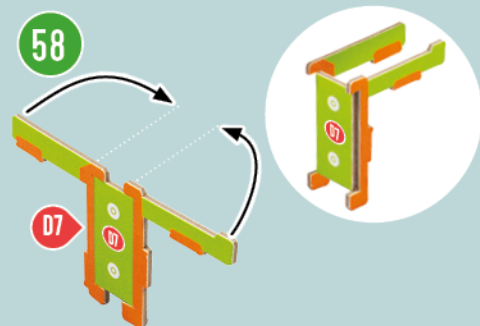
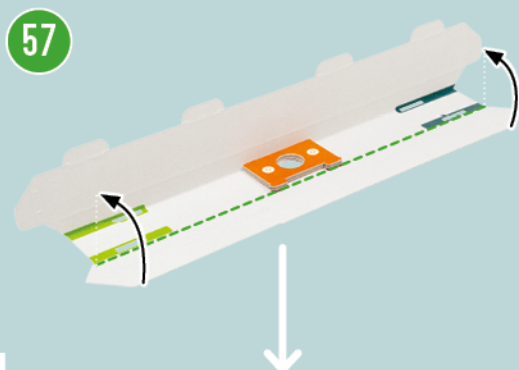
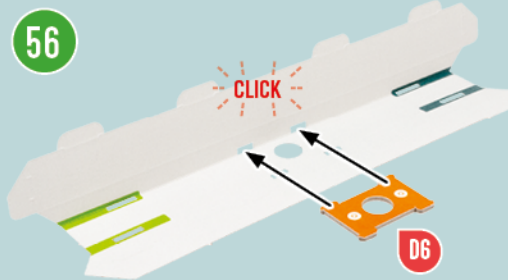

Need some help?  
Scan here for video  
instructions



Put to one side

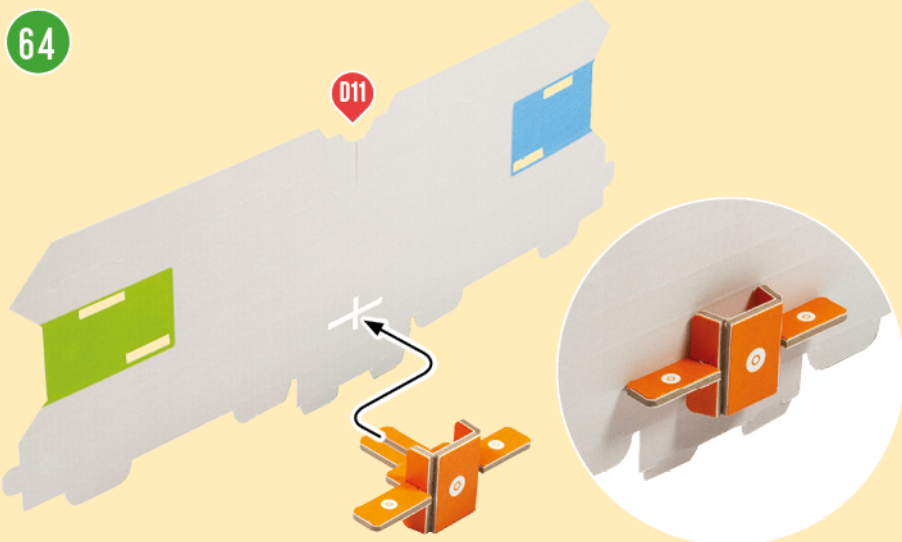
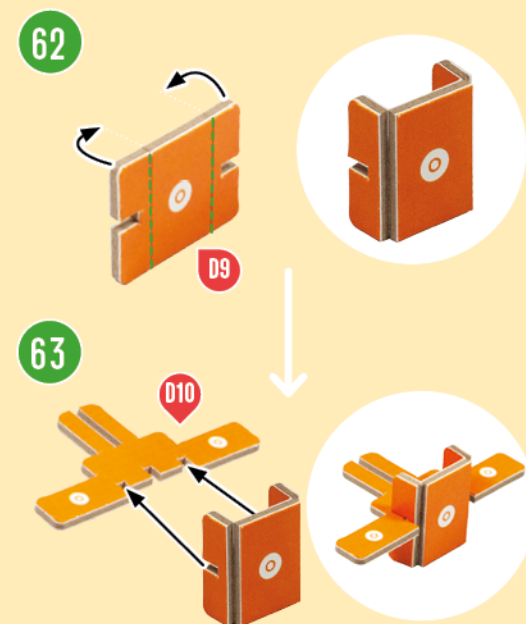

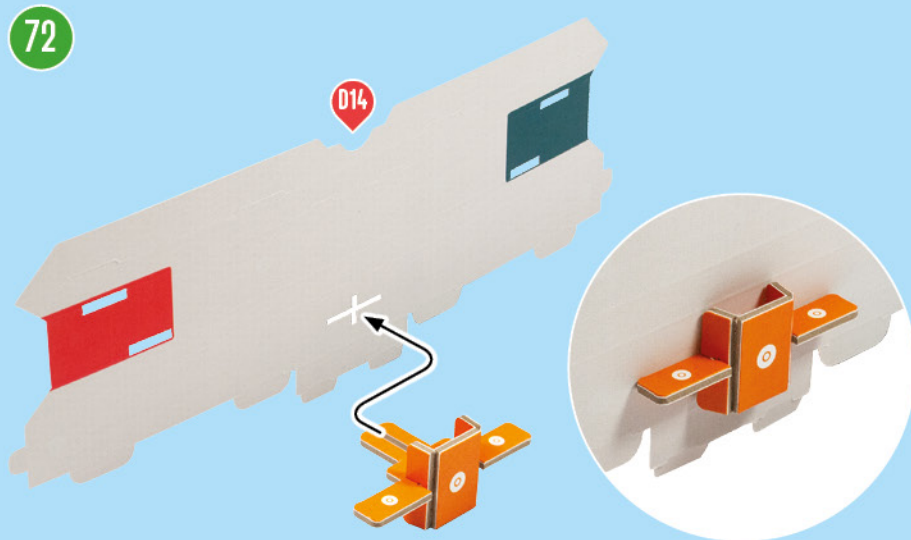
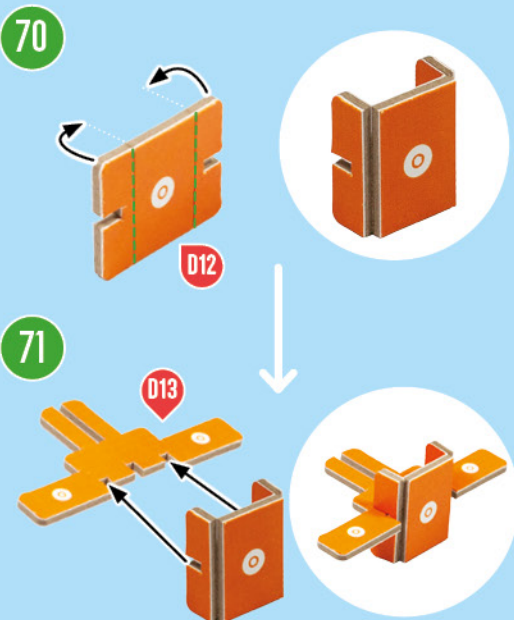
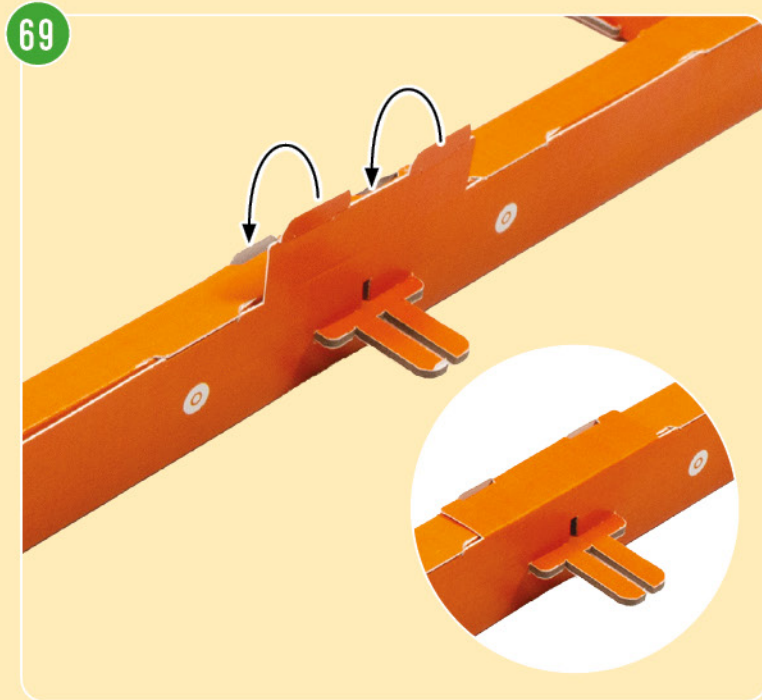
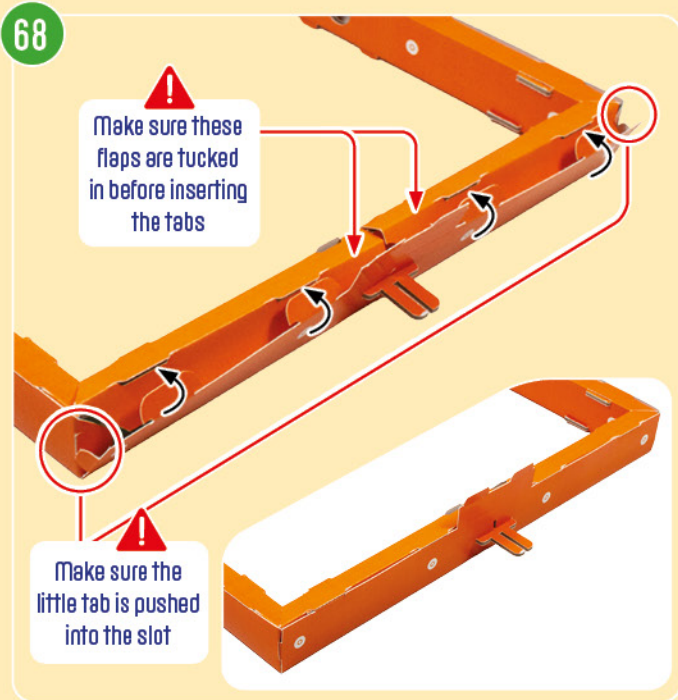
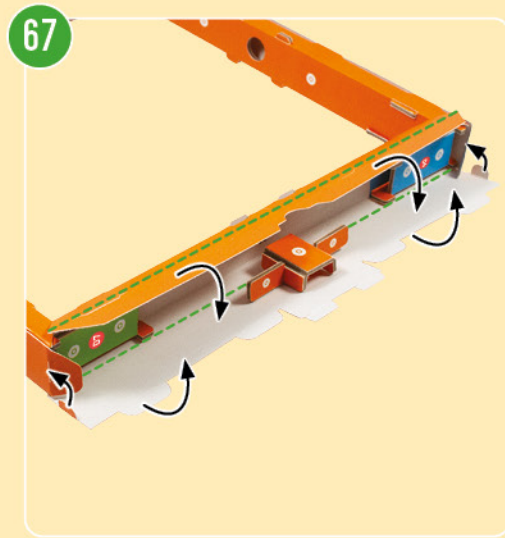
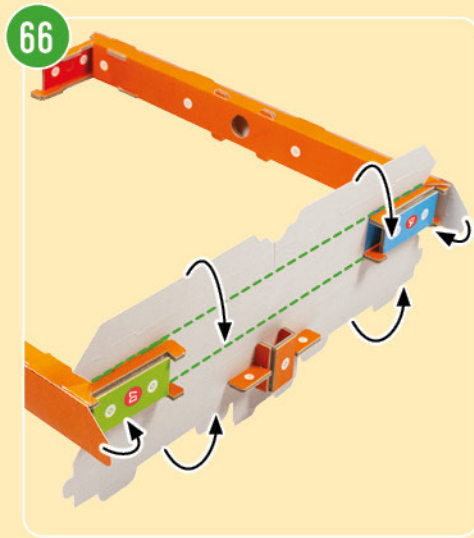
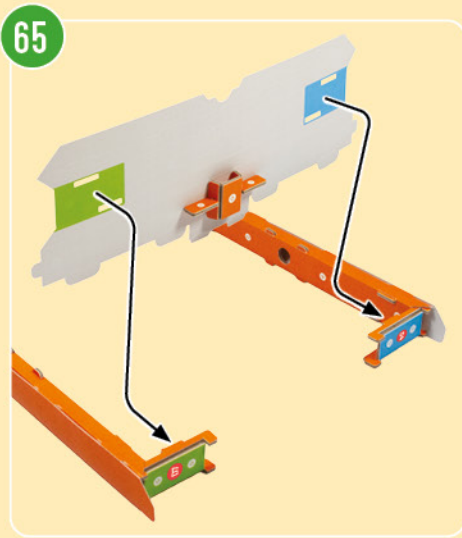

73

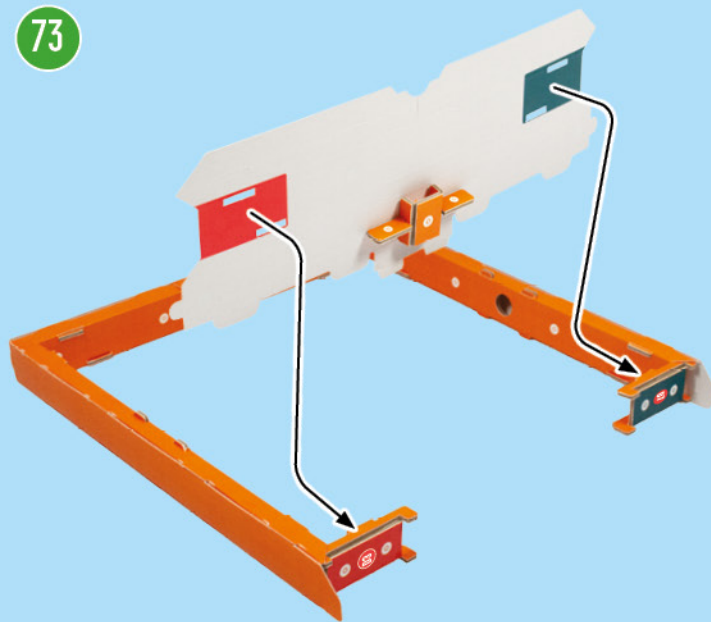

74

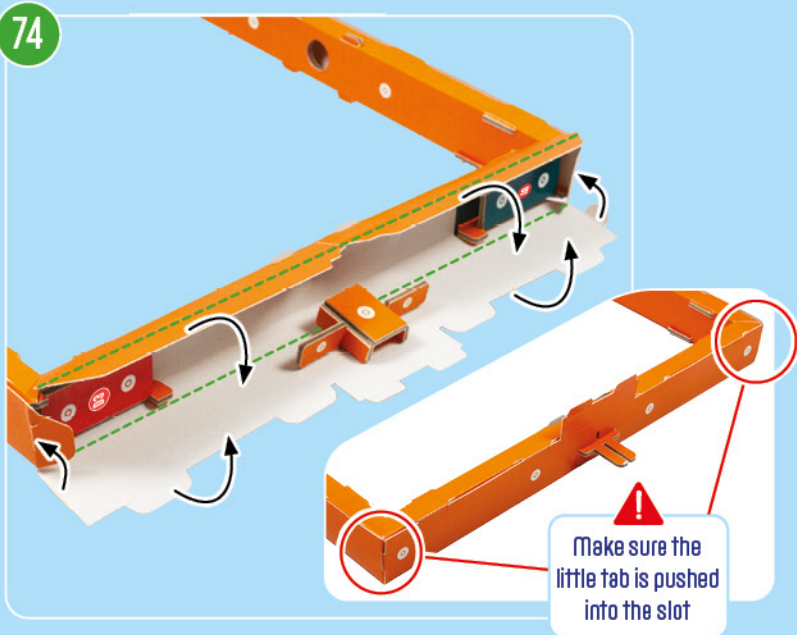

75



76

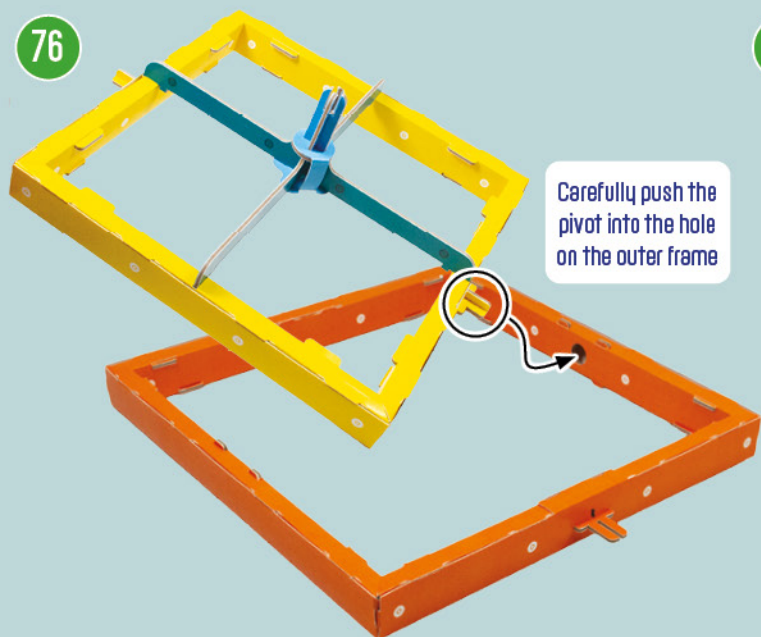

77

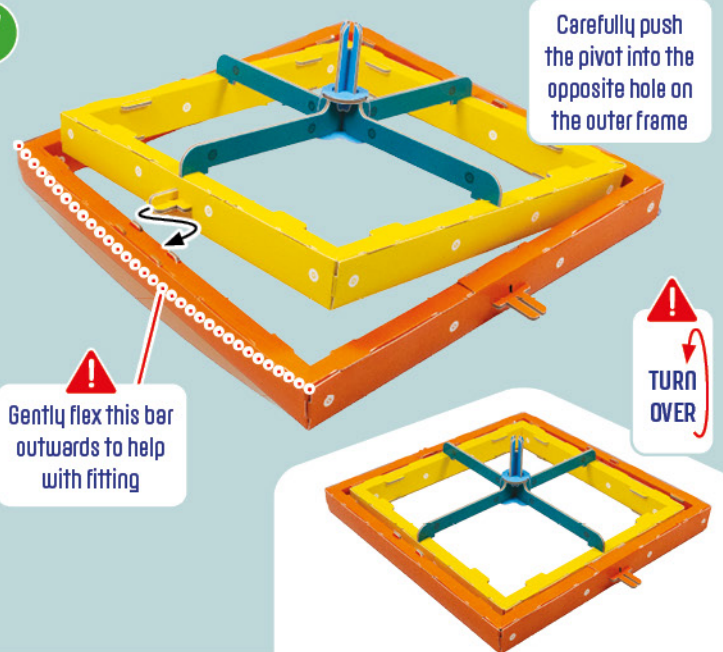

78

Carefully push the  
pivot into the hole  
on the frame

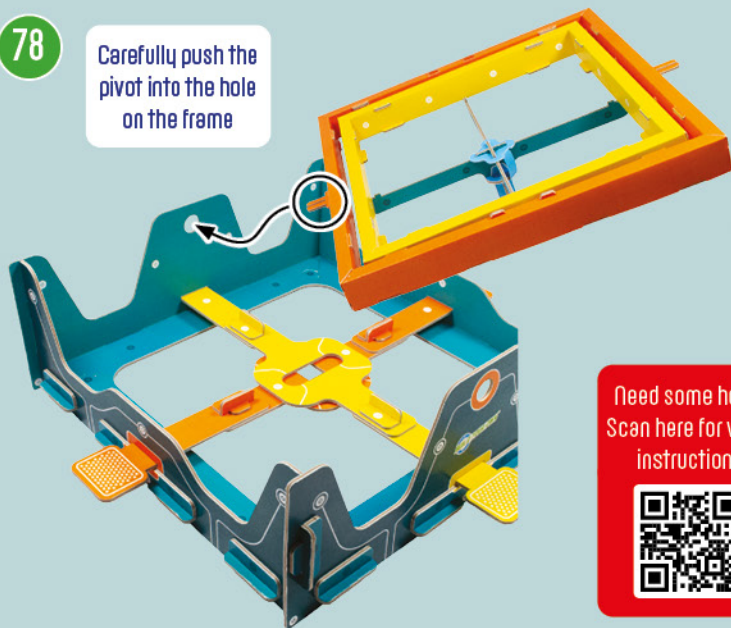

Need some help?  
Scan here for video  
instructions



79

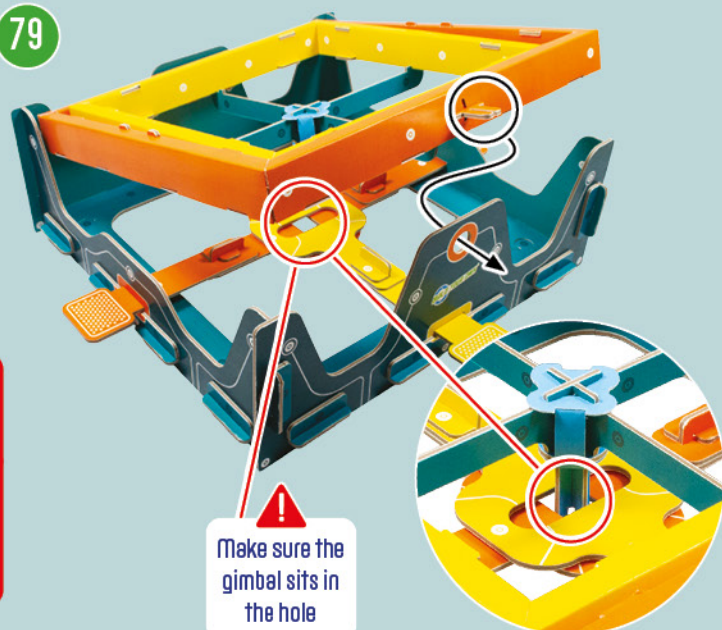

Make sure the  
gimbal sits in  
the hole

80

D15

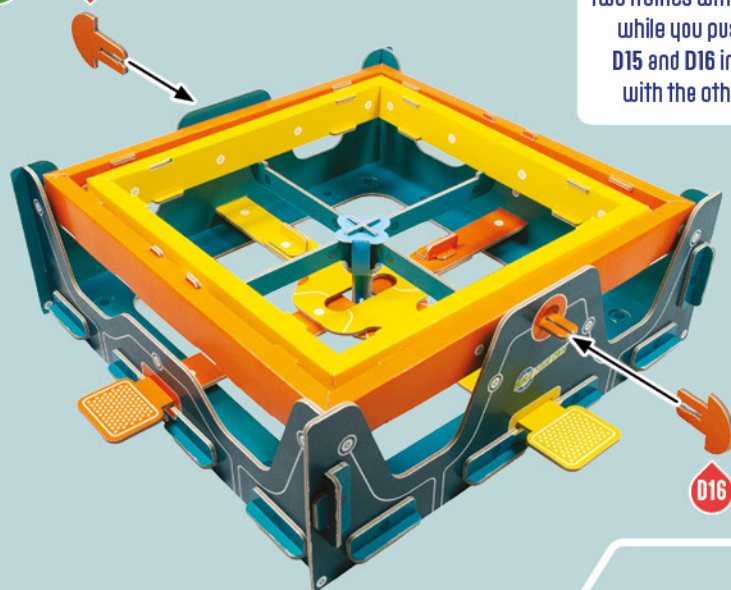

We suggest holding the  
two frames with one hand,  
while you push parts  
D15 and D16 into place  
with the other hand

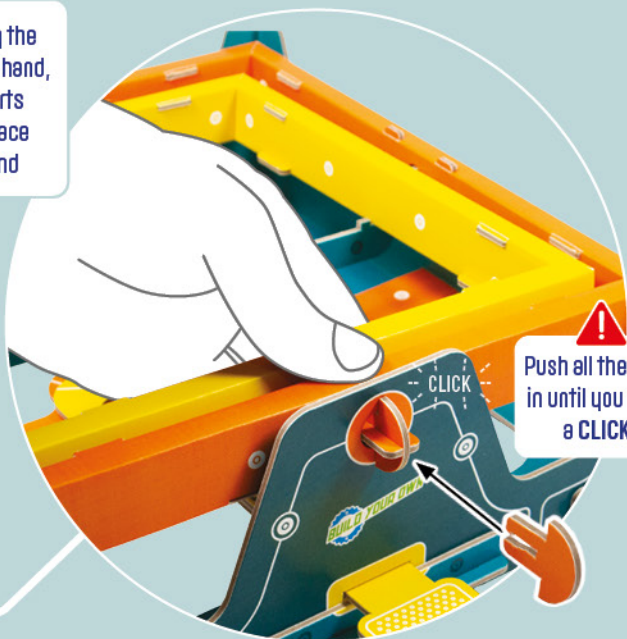

Push all the way  
in until you hear  
a CLICK



TURN  
OVER

These are the  
sheets you  
will need for  
this stage



81

D17

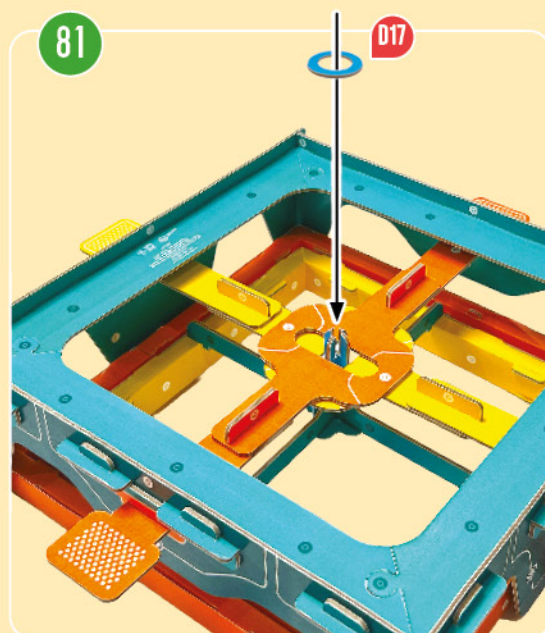

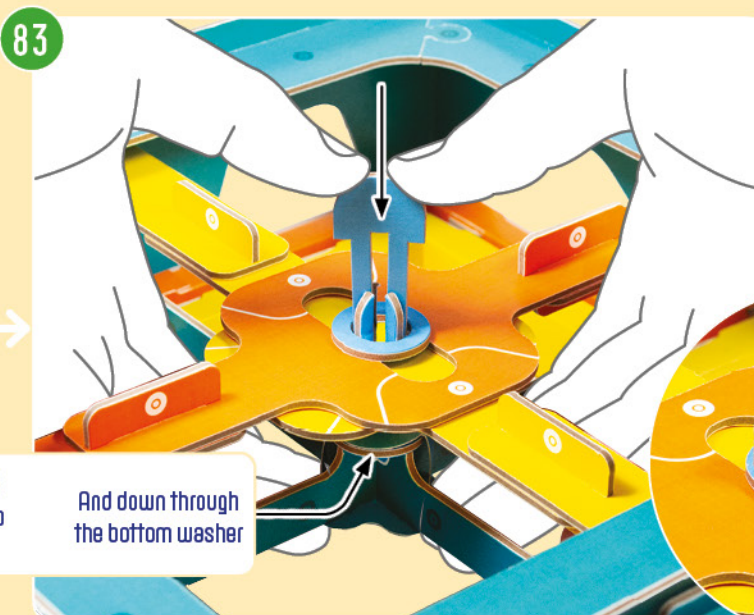
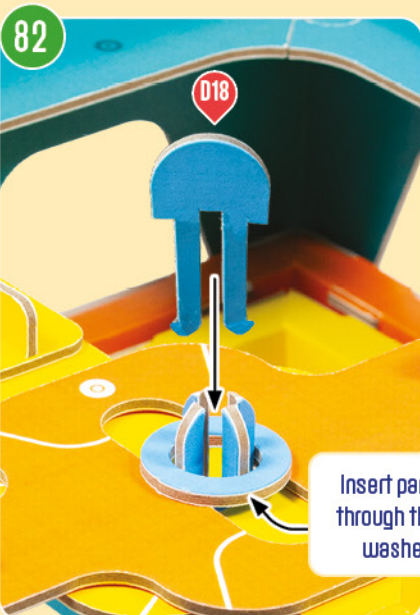

**!**  
We suggest gently placing your hands inside the mechanism like this, to support the bottom while you press down on part D18



These are the sheets you will need for this stage

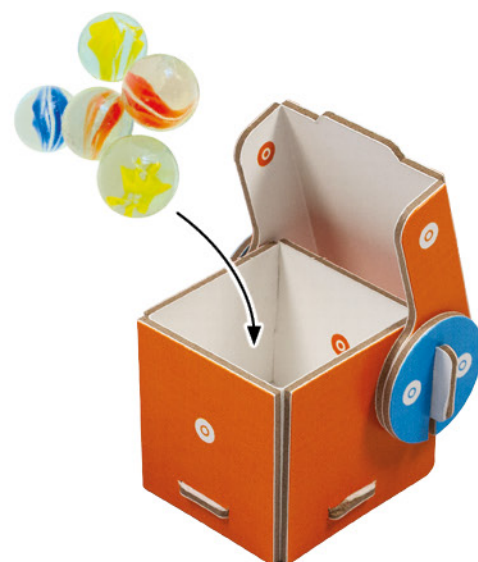
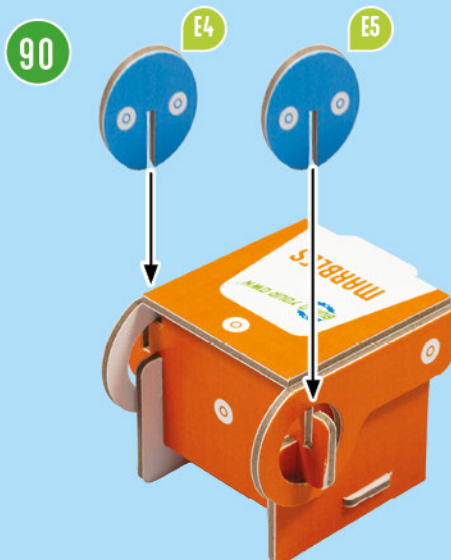
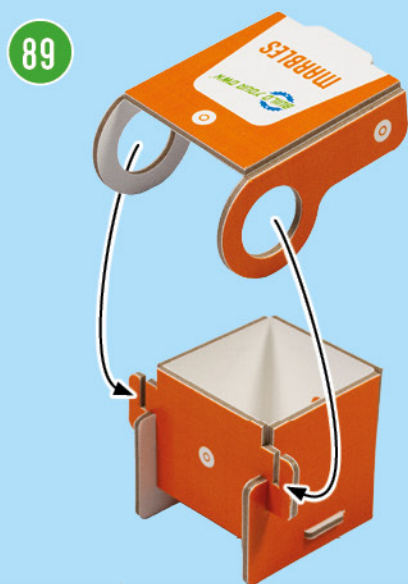
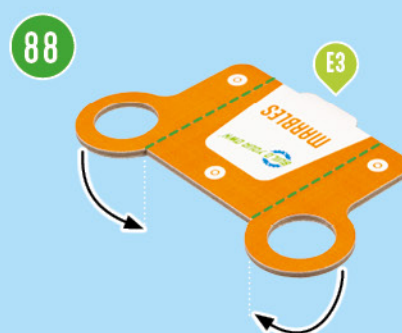
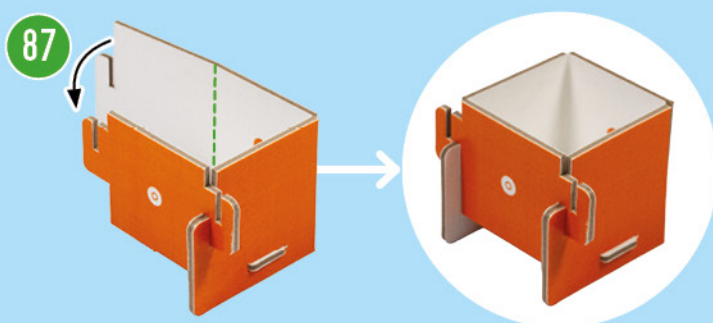
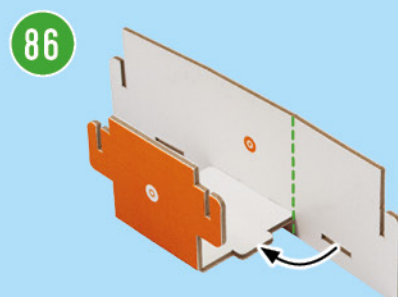
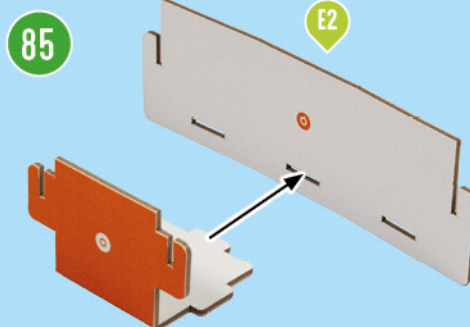
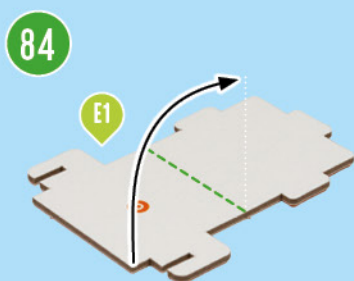
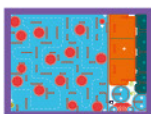

These are the sheets you will need for this stage

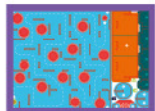

91

F1

Place one **LARGE** wall plate into each of the **YELLOW** highlighted slots

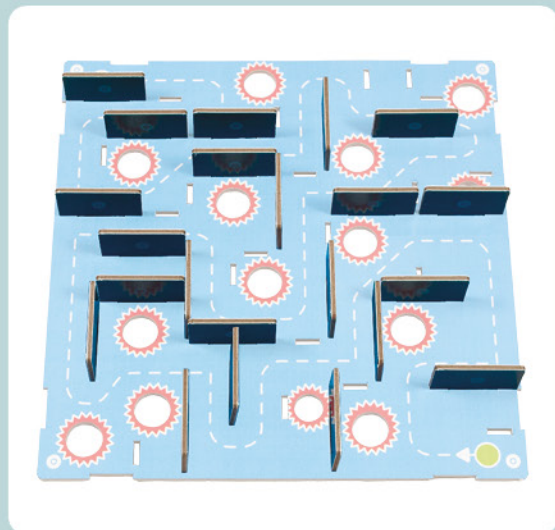
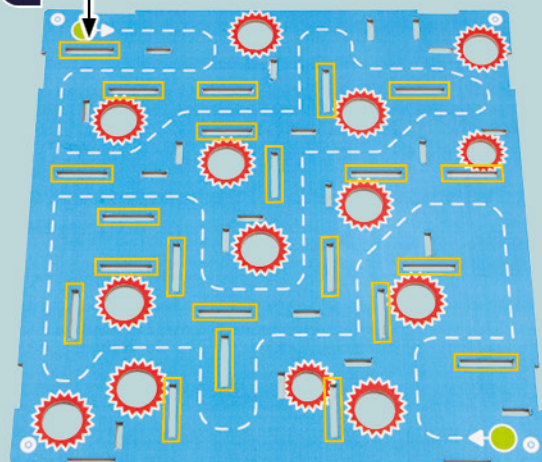

92

Place one **SMALL** wall plate into each of the **YELLOW** highlighted slots

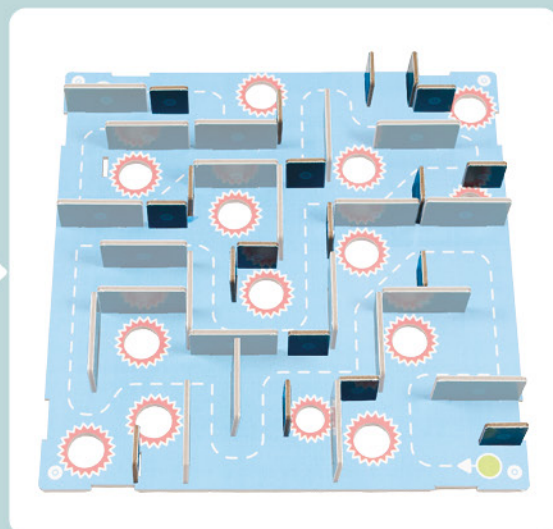
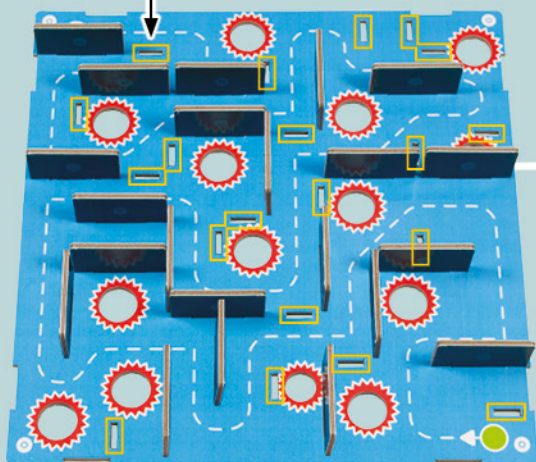

93



# MASTER THE MOVES!

1

Move the **ORANGE** paddle in and out to tilt the maze in one direction



2

Move the **YELLOW** paddle in and out to tilt the maze in the other direction



3

Combine moving the **ORANGE** and **YELLOW** paddles to manoeuvre the marble through the Labyrinth

## HOW TO PLAY

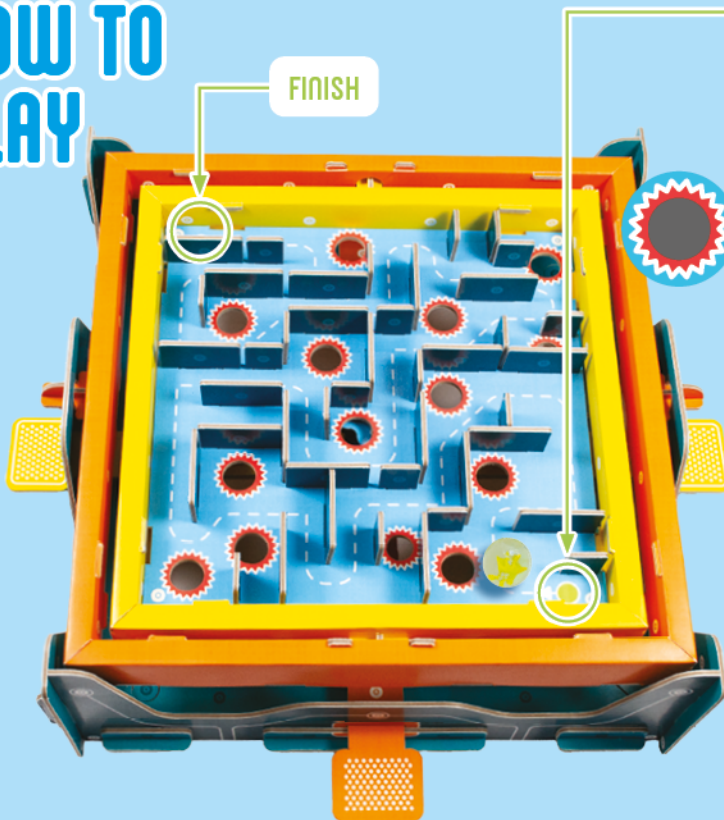

Place your marble at the **START** point. Now push and pull the **ORANGE** and **YELLOW** paddles, tilting the Labyrinth to navigate the marble to the **FINISH**.

**But beware of the traps!**

If your marble drops into one of the holes, you must go back to the **START** and try again. You will need practice and a steady hand. Take your time and before long you'll be a **LABYRINTH MASTER**!

Extra challenge:

Once you've mastered the Labyrinth, remove the walls and flip over the base board. Now rebuild the walls. Everything is in reverse and the challenge starts again.

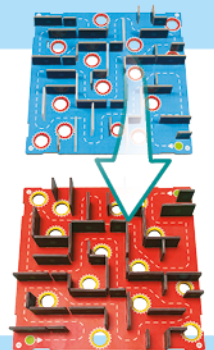

## MARBLE FRENZY GAME

**MARBLE FRENZY** combines the skills you've learnt from mastering the Labyrinth with the craziness of **FIVE** marbles! Replace the Labyrinth board with the **MARBLE FRENZY** board. Tilt the frame down in the back right corner and place five marbles in the **START** area. Now use your skills to get each of the marbles into the scoring holes. But mind the trap holes! If a marble falls through a hole, deduct 5 points from your score and that marble is out of play.

**Good luck!**



# WHAT IS A LABYRINTH?

A **Labyrinth** is a complicated maze-like pattern, normally underground, as referenced in Greek mythology. **Labyrinths** have appeared in many ancient cultures including Egypt and India. Mazes and Labyrinths often refer to the same thing, but usually they differ in one important way:

**Maze:** A puzzle with multiple branching paths and a choice of direction.

**Labyrinth:** A puzzle with one path to the centre.



## Theseus and the Minotaur

In Greek mythology, the **Minotaur** was a creature with the body of a man and the head of a bull. It ate humans, so **King Minos** of **Crete** trapped it in a giant maze called the **Labyrinth**.

After his son was killed by soldiers from **Athens**, **King Minos** took revenge by sending seven boys and seven girls from **Athens** into the maze every year to face the **Minotaur**.

One year, a brave prince named **Theseus**, son of the King of Athens, volunteered to stop it. He brought a red thread, which he unrolled as he went into the **Labyrinth**, so he could find his way back.

**Theseus** found the **Minotaur**, fought and killed it, then followed the thread out and saved the other children. He became a hero!

# WHAT IS A GIMBAL?

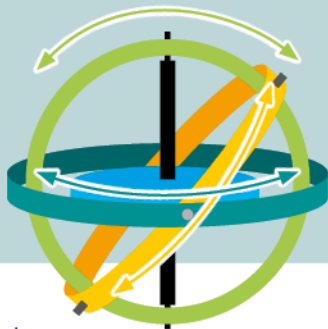

Your Marble Labyrinth uses a mechanism called a **Gimbal** to let you tilt the table in two directions—forward and sideways. A **Gimbal** is a special frame with pivots that lets an object spin or tilt while being held up.

In your Marble Labyrinth, the two outer frames act as **Gimbals**. When you slide the paddles, they tilt the table so you can move the marble through the Labyrinth.

**Gimbals** are also used on ships to keep things from tipping over when the ship rocks. If you use three **Gimbals** around something, it can stay upright even if everything around it moves. That's why filmmakers use **Gimbals** too—they help keep the camera steady while filming, even if the person holding it is moving.

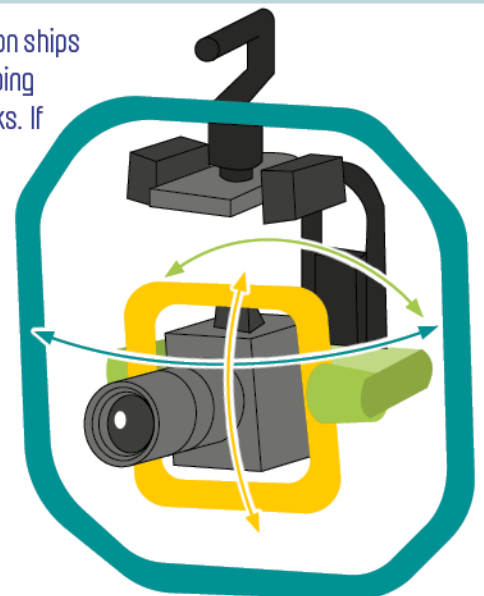

# HELP!

If you get stuck building our kit or the dog has eaten a part, get in contact and we will do our best to help.

Go to  
**BuildYourOwnKits.com**



Email us  
**support@buildyourownkits.com**

Or talk to a real person!  
Phone us on 023 8062 5855

Find us on  
social media



Scan here for  
quick access to our  
support page.



## WANT MORE?

Head over to our website  
to see all our amazing kits.

**BuildYourOwnKits.com**



**WARNING:** Choking hazard. Small parts and small balls. To be used under the direct supervision of an adult. Not suitable for children under 3 years. Retain this packaging for future reference. Recommended age 8+.

Paper Engine Ltd, MacLehose House, Unit A, Woodside Trade Centre, 34 Parham Drive, Eastleigh, Hampshire, SO50 4NU, UK

**EU Authorised Representative,** Vulcan Consulting, 38/39 Fitzwilliam Square West, Dublin 2, D02 NX53, Ireland

© Paper Engine Ltd 2022 [www.paperengine.com](http://www.paperengine.com) Product Code: BYO 010 R2 Printed and manufactured in Heshan, China by Hung Hing Printing Group 05/2025  
Additional artwork courtesy of Vecteezy.com