

# MATILDA

## Book Nook

Slot together cardboard kit

### Building Tips

1. Use the **Removal Tool** to push out the smaller pieces of card.
2. Pre-crease all the folds before you build each step unless otherwise stated.
3. If you get stuck, try looking at the next few steps to help you out.
4. **Don't rush!** Make yourself a cuppa and take your time while building.



Scan here  
for video  
instructions  
and more!

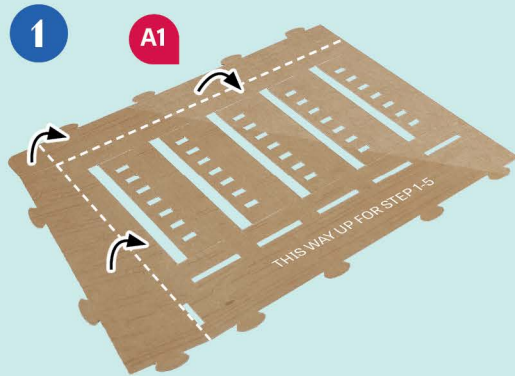

Fold books  
as shown

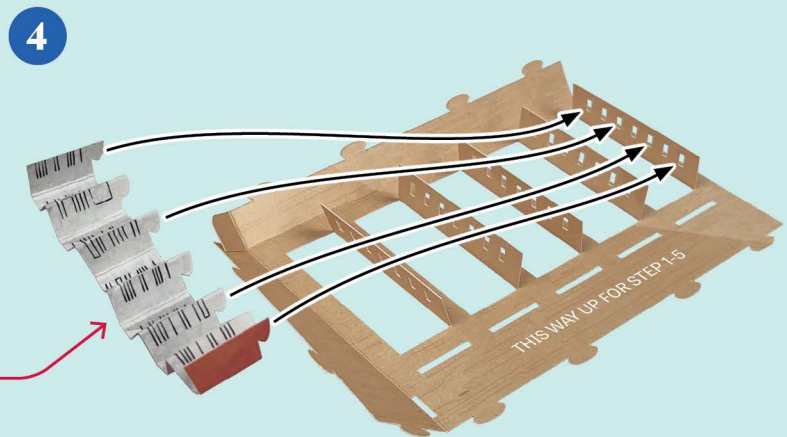

- 5
- Repeat Steps 3-4 with all books
- A3 A4 A5 A6

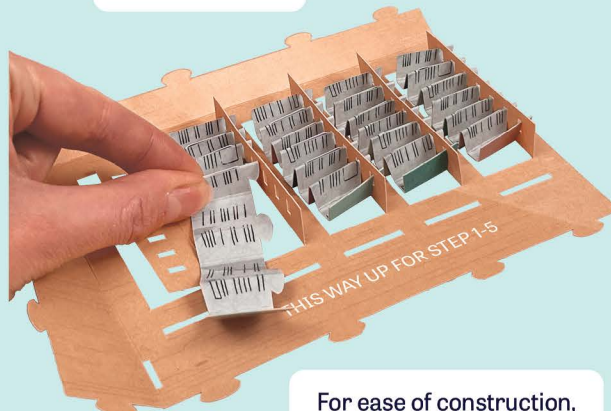

For ease of construction,  
lay the bookcase down and  
pinch the books as shown to  
fit each tab into the slots

### Large Bookcase



Put to one  
side until  
Step 39



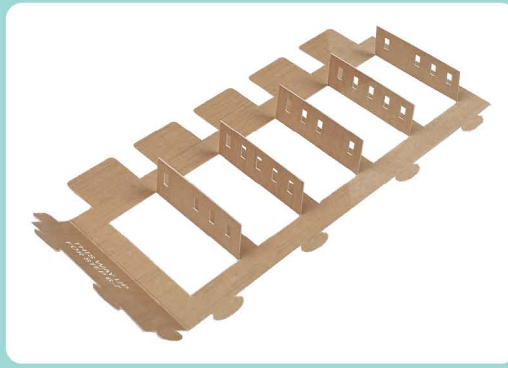
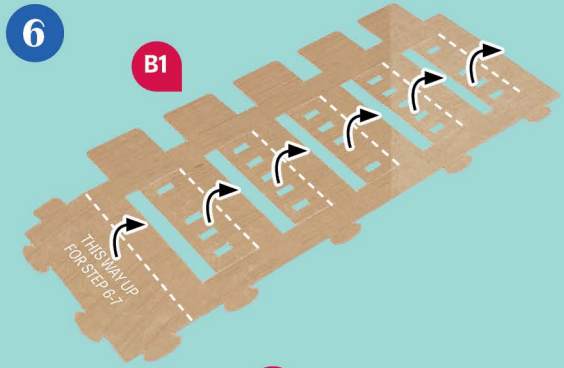

## Small Bookcase

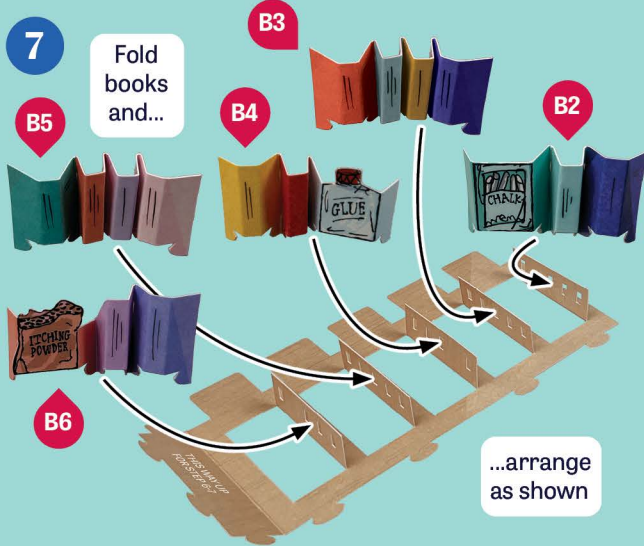

Put to one side until Step 40

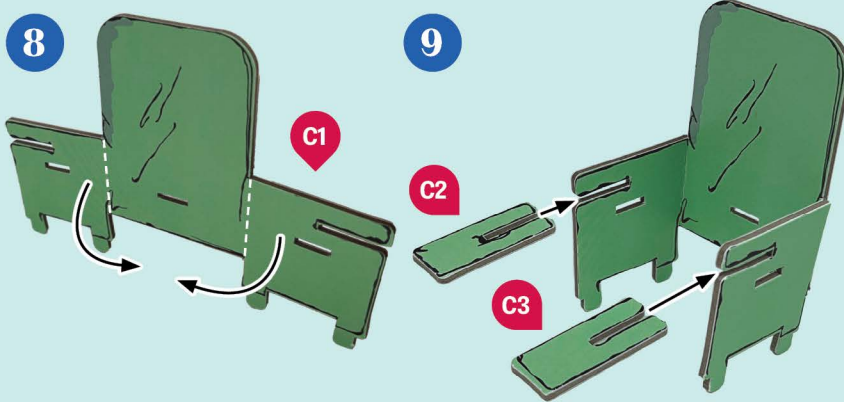

### Butterfly Tabs

When you see the butterfly icon follow these directions.

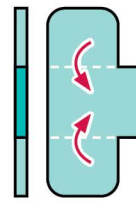

Fold flaps in

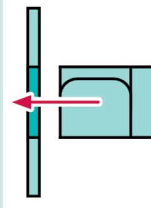

Push tab through slot

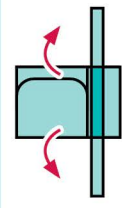

Unfold flaps to lock

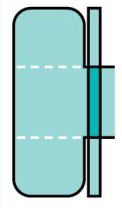

Flaps should be flat

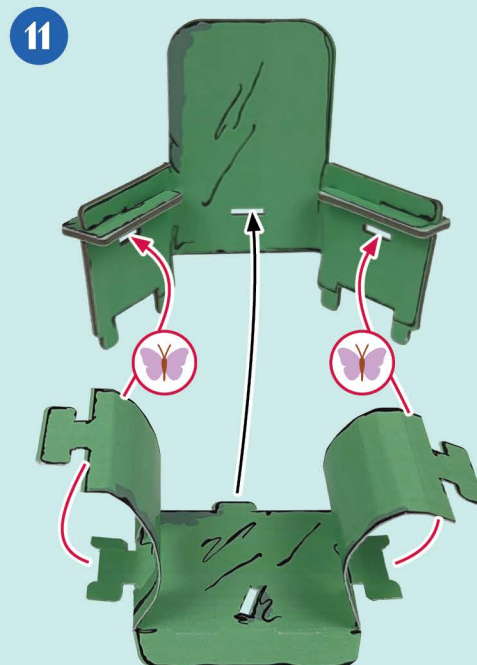
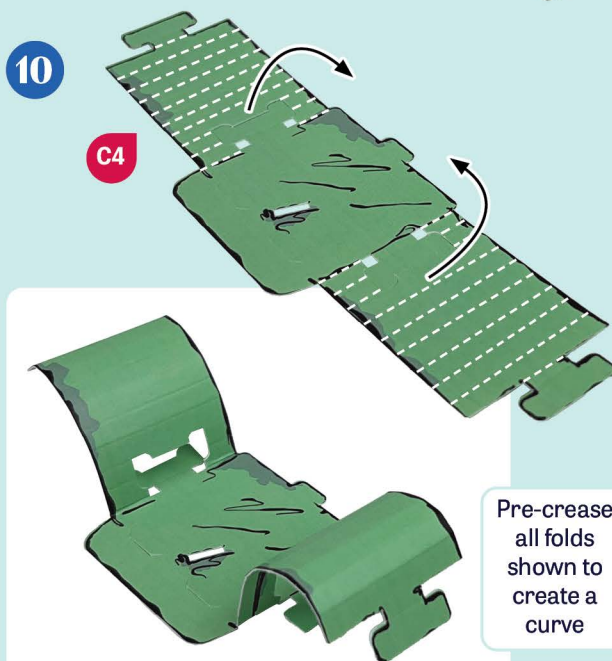

Ensure the flaps are unfolded and flat as shown



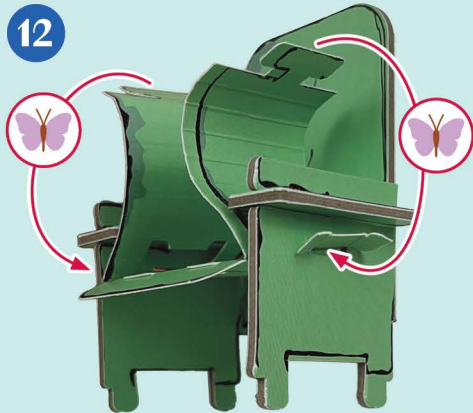

Matilda & Armchair

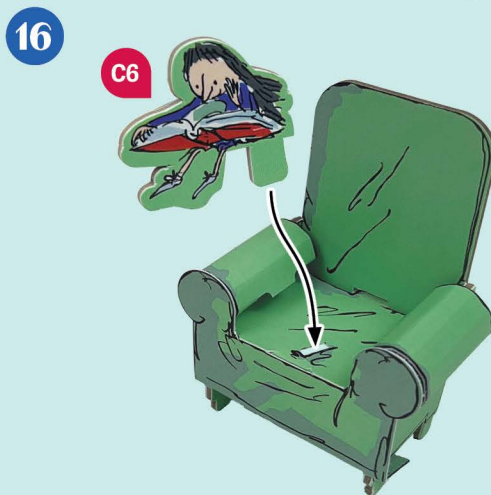

Put to one side until Step 54

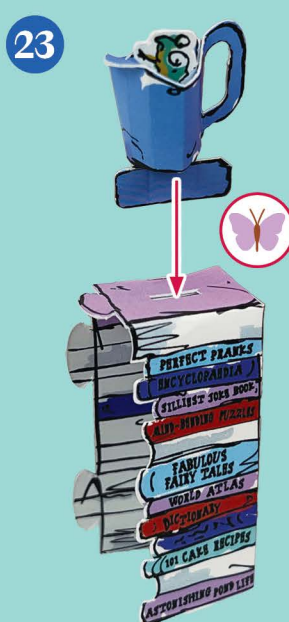
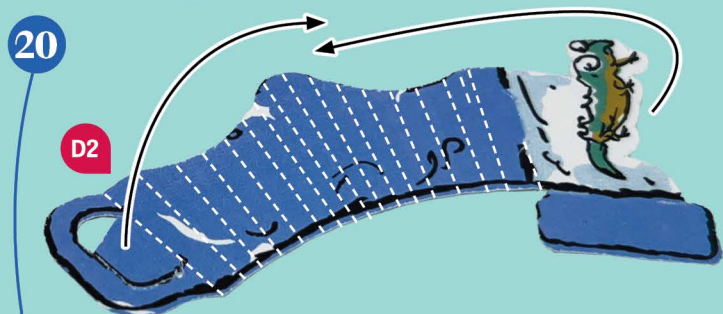

Book Stack & Newt in Jug



Put to one side until Step 41



24

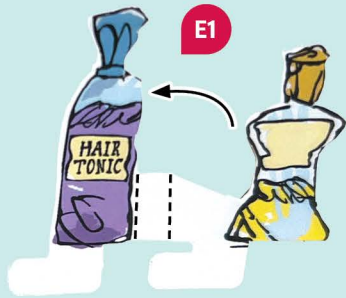

25



## Tabletop



26

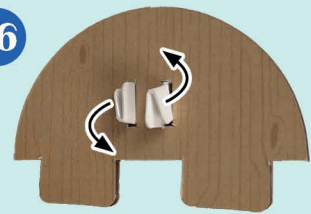

27

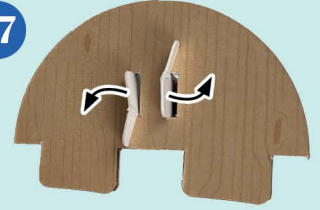

Ensure the flaps are unfolded and flat as shown

Put to one side until Step 44



28



29



30

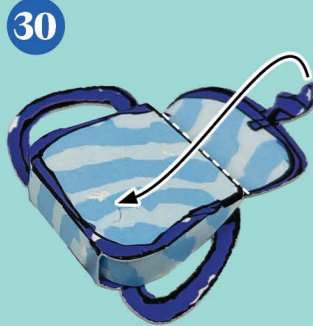

## Backpack



Put to one side until Step 50

31

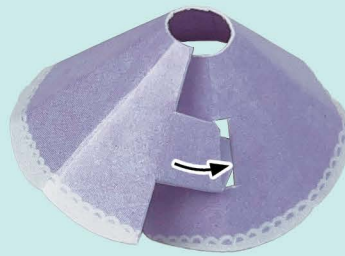
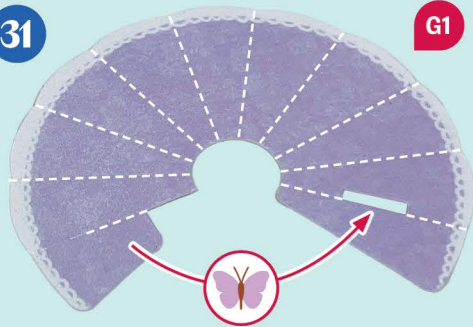

32



33



## Ceiling Light



Put to one side until Step 48



34

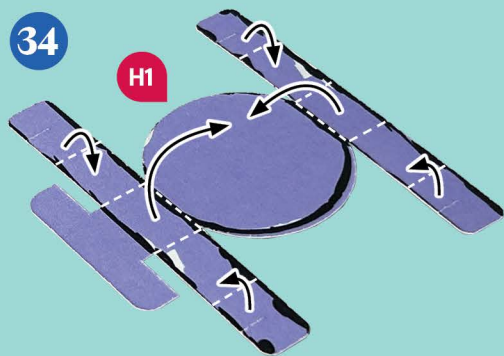

35



Clock



Put to one  
side until  
Step 39

36

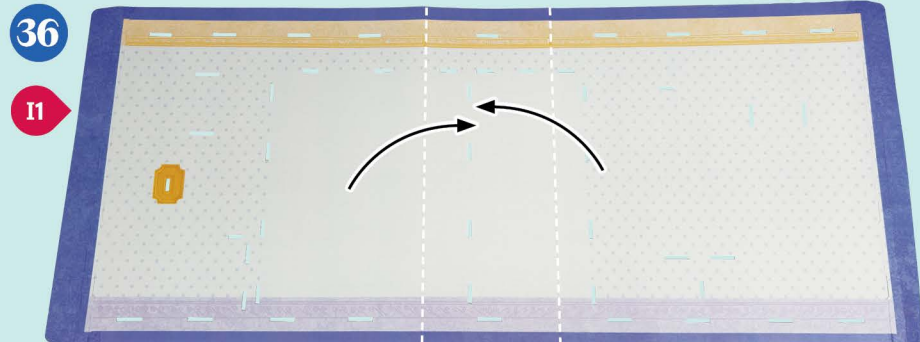

37

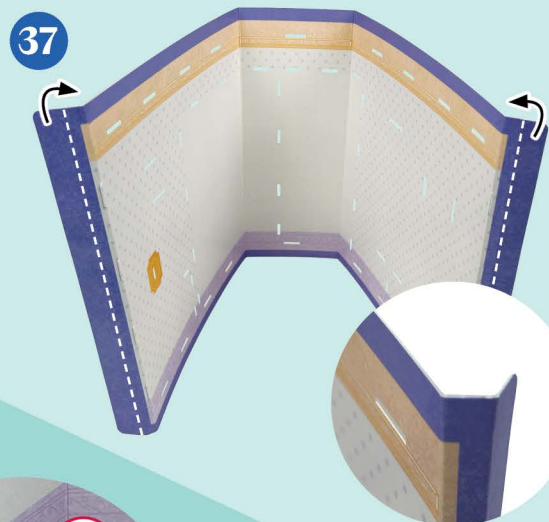

38

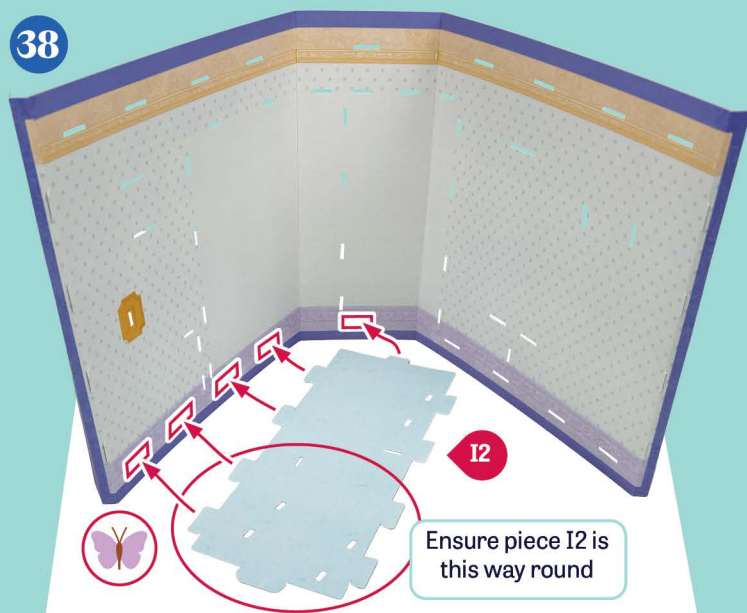

Ensure piece I2  
is this way round

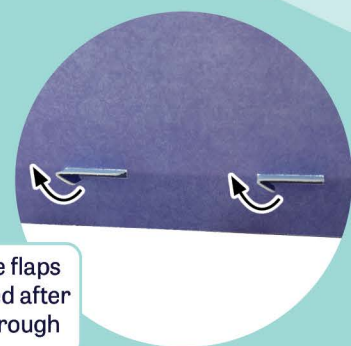
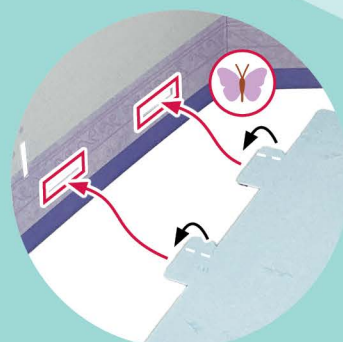

Ensure the flaps  
are unfolded after  
slotting through

39

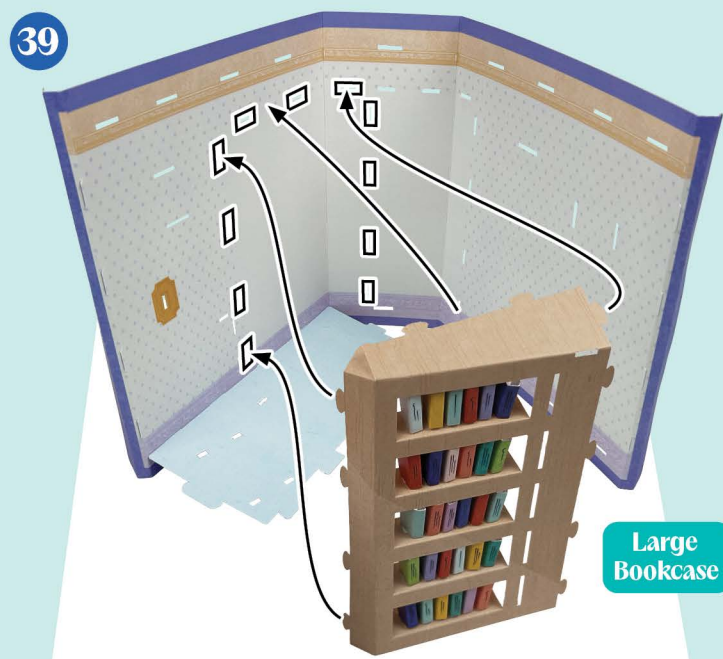

Large  
Bookcase

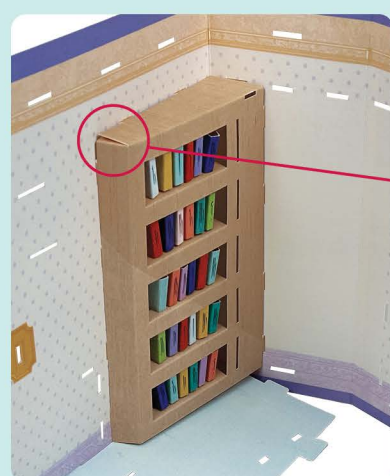



40

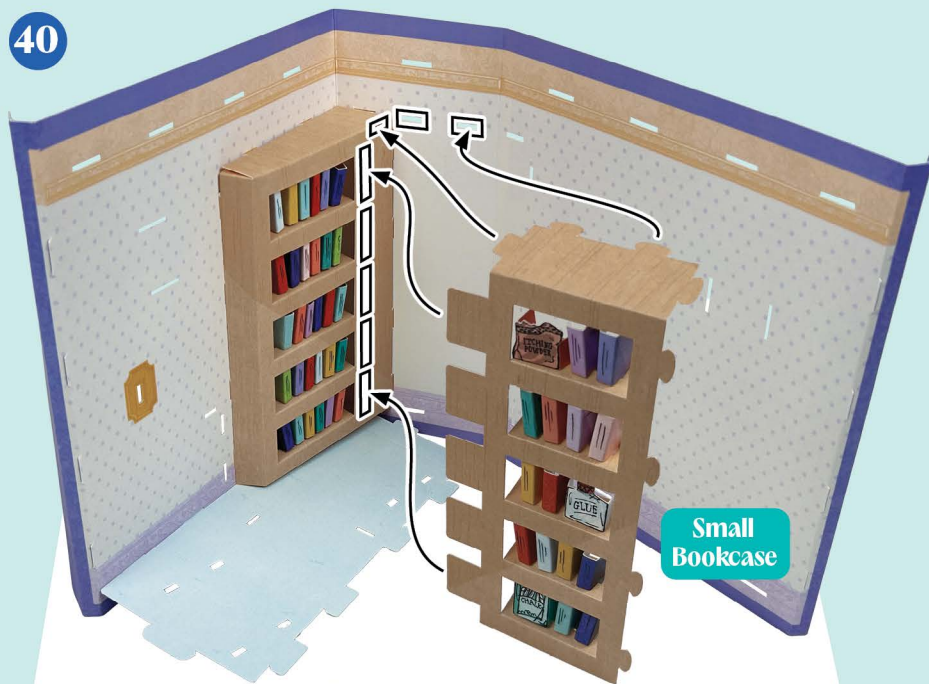

41

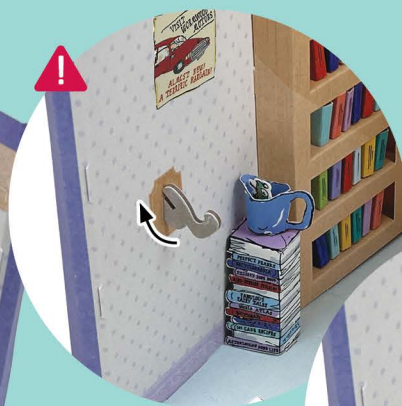
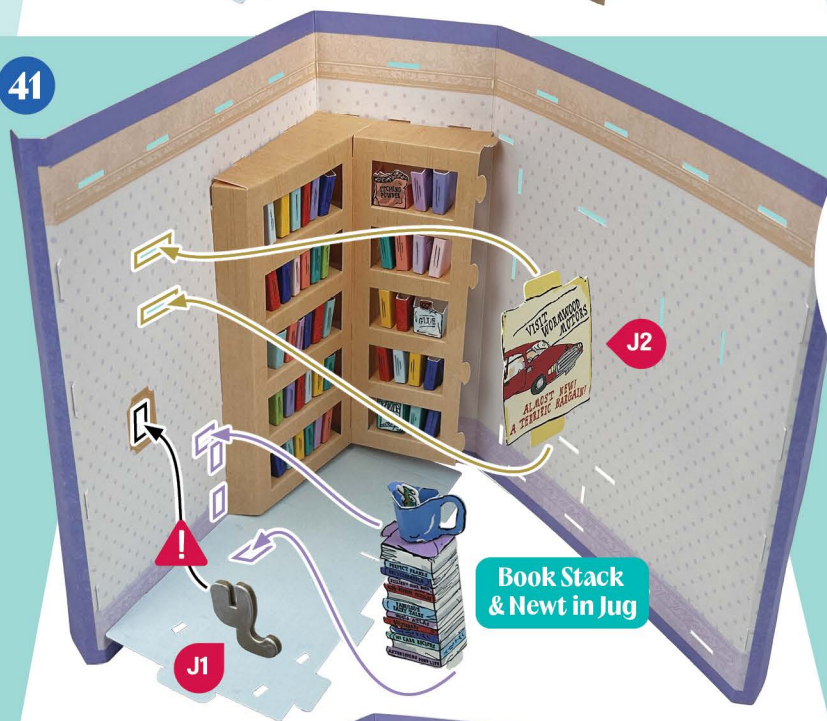

42

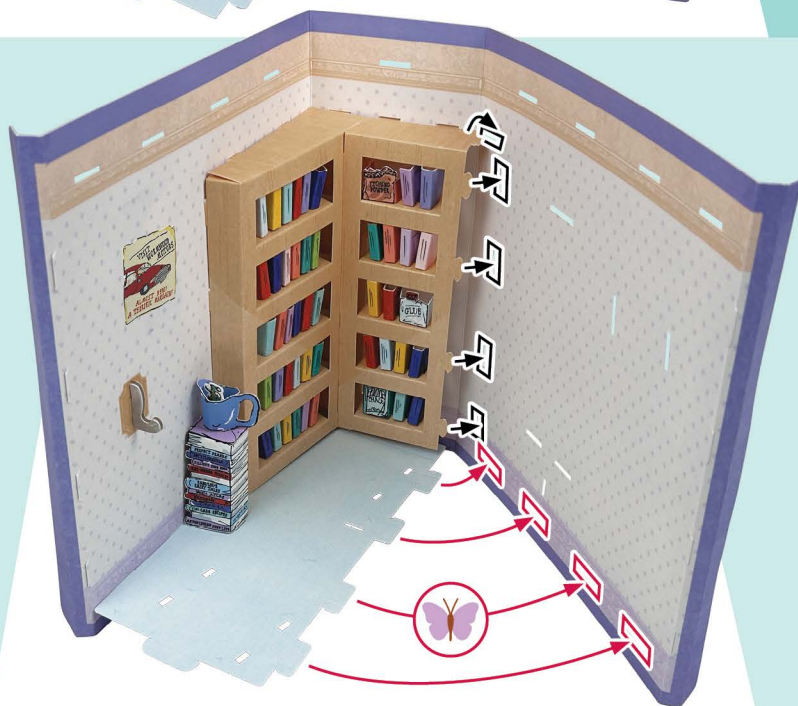



43

K1

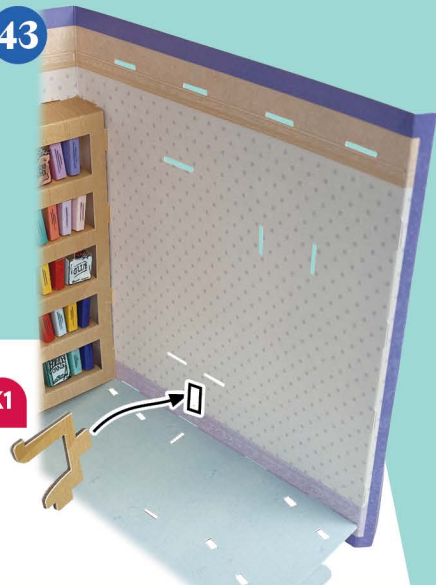

44

Tabletop

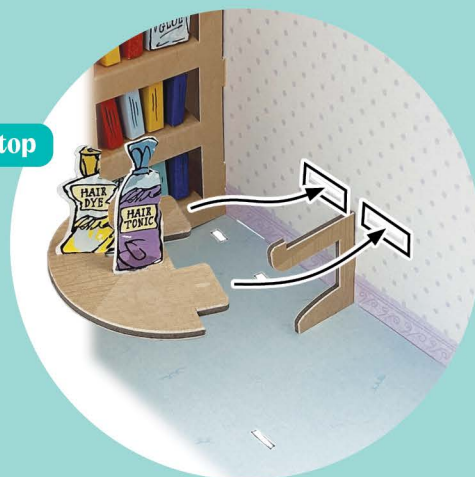
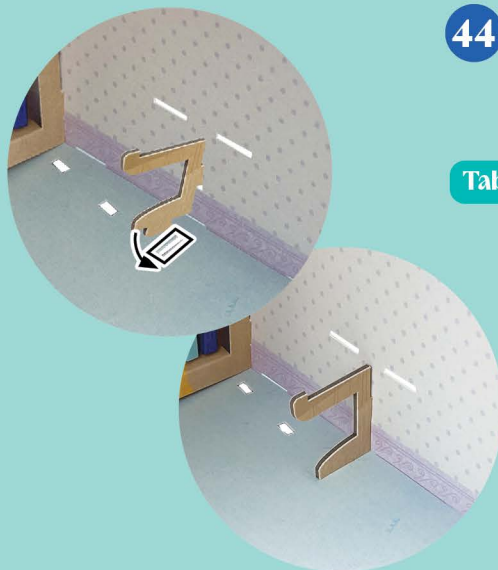

45

K2

Clock

K3

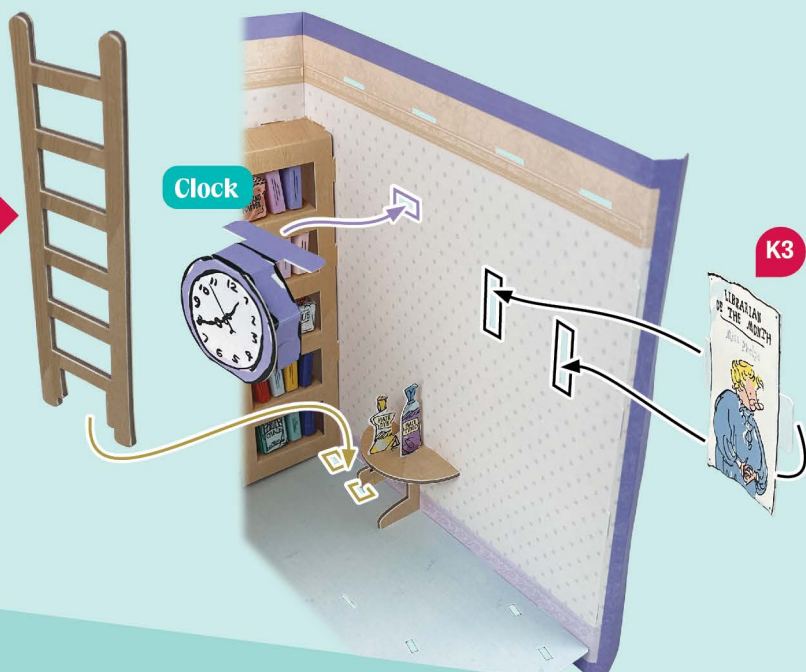

46

I3



47

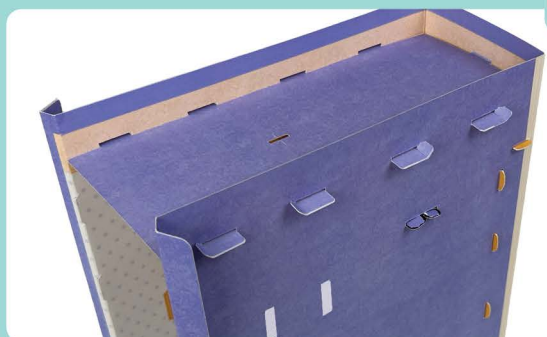
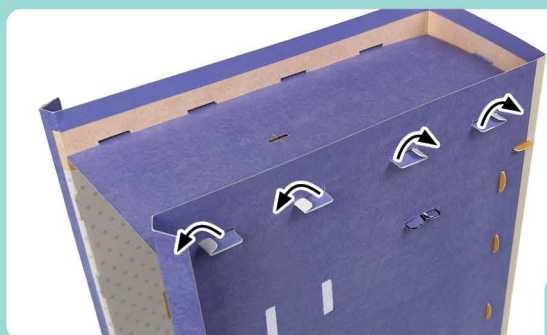

Ensure the flaps are unfolded after slotting through

48



49

Ensure the flaps are unfolded after slotting through

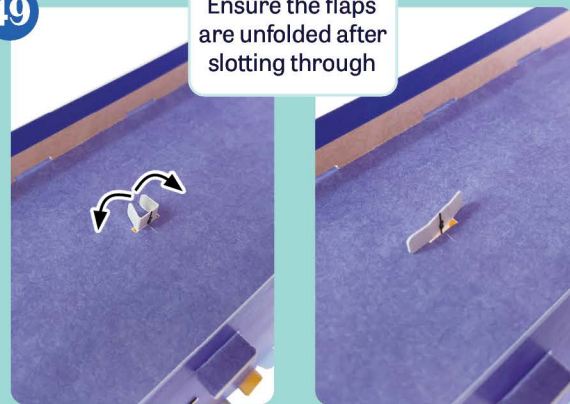

50

BACKPACK



51

14

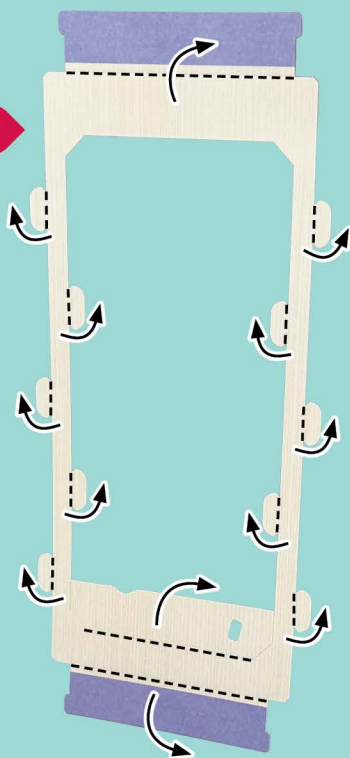

Prefold all creases shown

52

Slot in highlighted tab first, followed by all other tabs

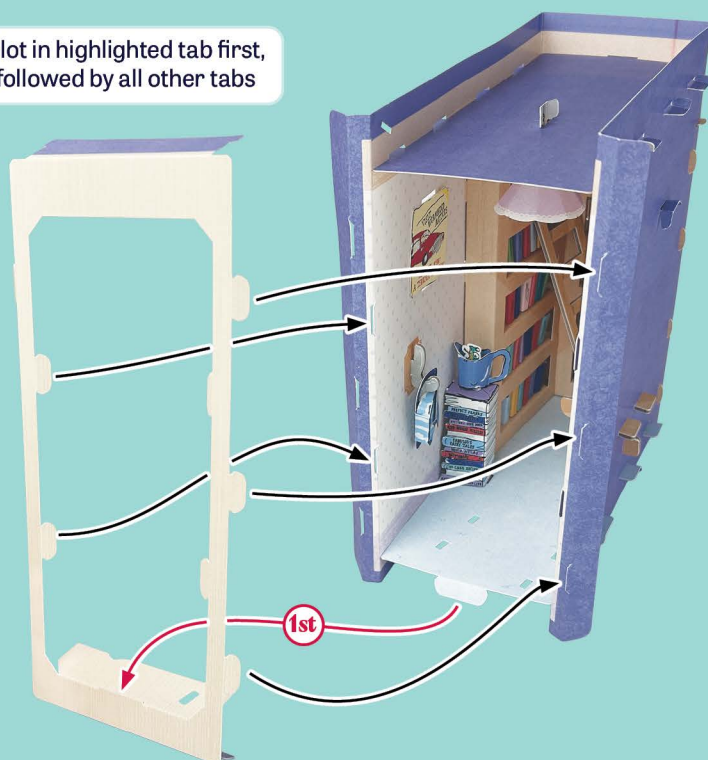



53

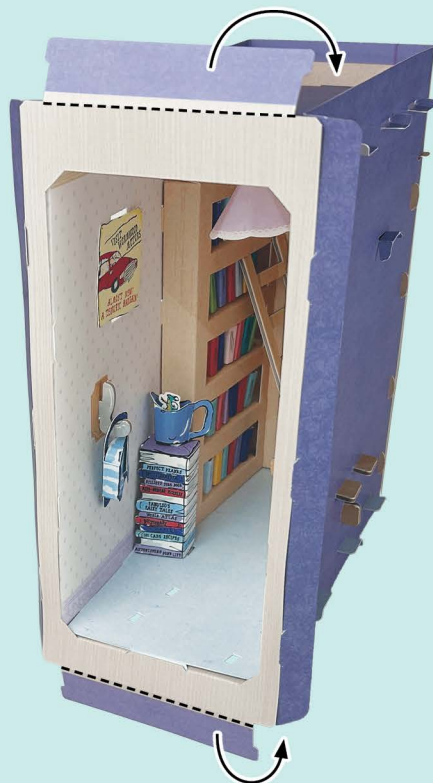

Ensure the tabs **click** into the highlighted slots



Do this at the top and base

54



Matilda & Armchair

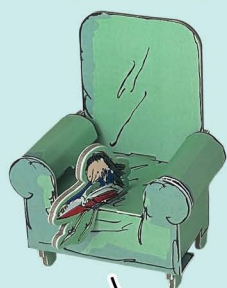

Put to one side until Step 59

55

Cover

BACK COVER

FRONT COVER

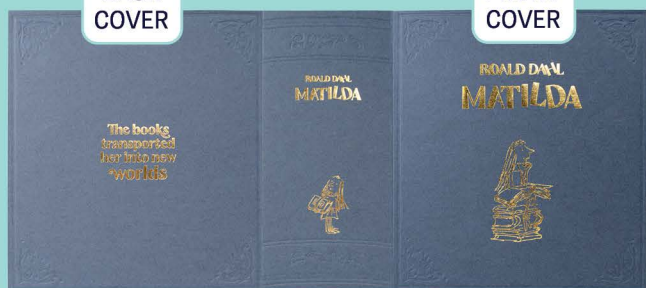

TURN OVER

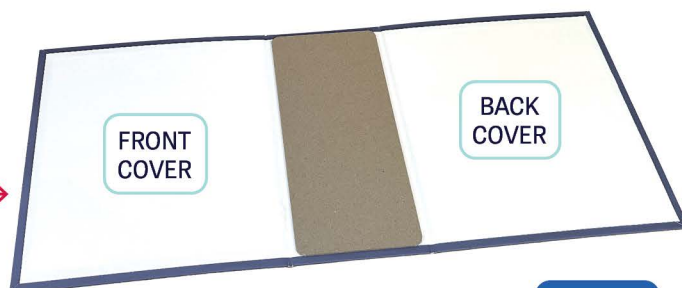

Put to one side until Step 57



56

Unfold the  
box section

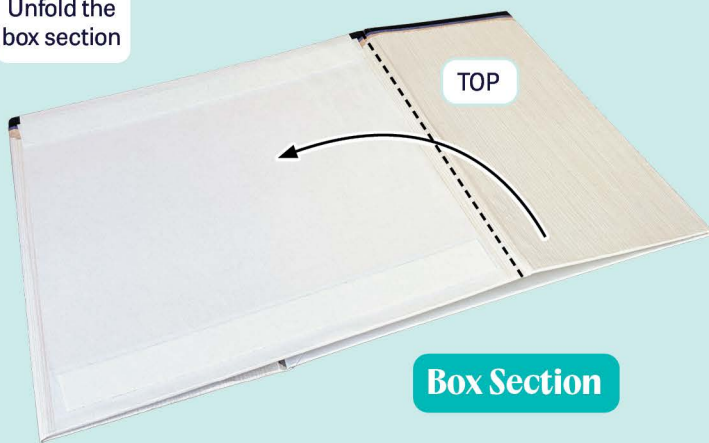

Box Section



57

Ensure the cover and box  
section are in the correct  
orientation as shown (blue  
band against the cover)

Use the raised alignment  
piece to position the box  
section on the cover

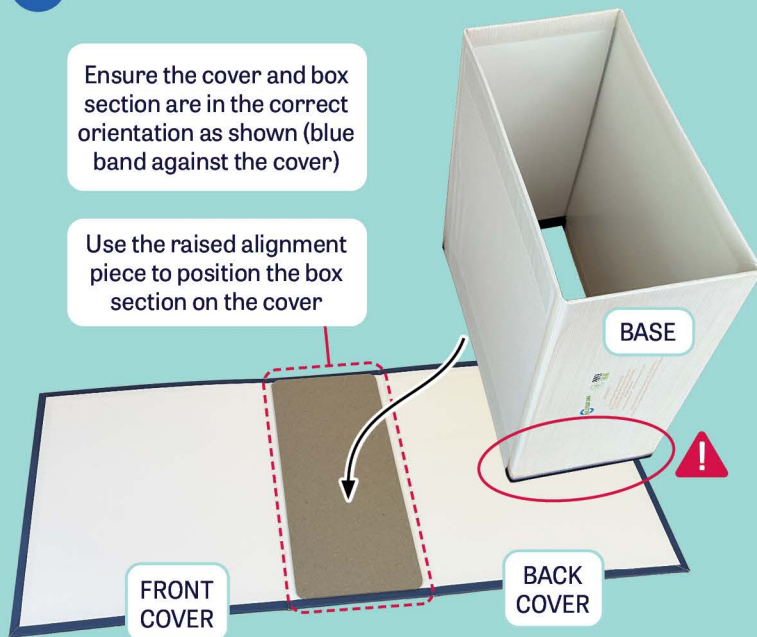

**READ THESE TIPS  
before the next step:**

Once the tape is stuck it  
is very hard to remove, so  
**check twice, stick once!**

Fold up the sides of the cover to check they  
are straight and you have an even border of  
the cover around the box section

Double check the cover  
and box section are in the  
correct orientation

58

Peel off the backing  
of the tape on both  
sides, and then  
carefully fold up the  
sides of the cover

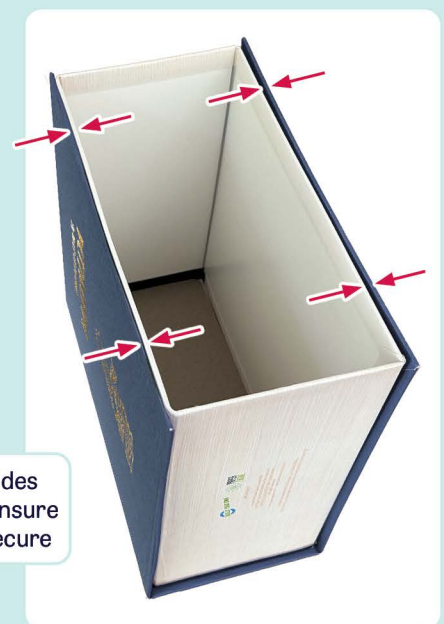
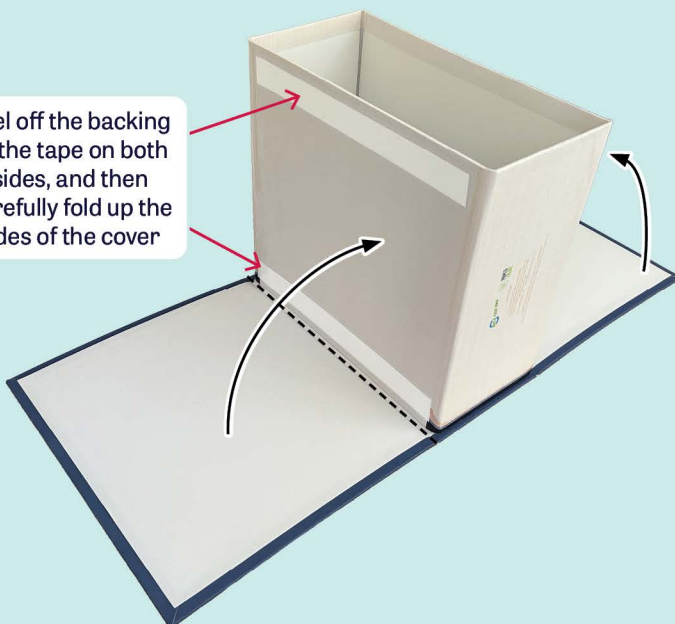

Pinch the sides  
together to ensure  
the tape is secure



59



Done!

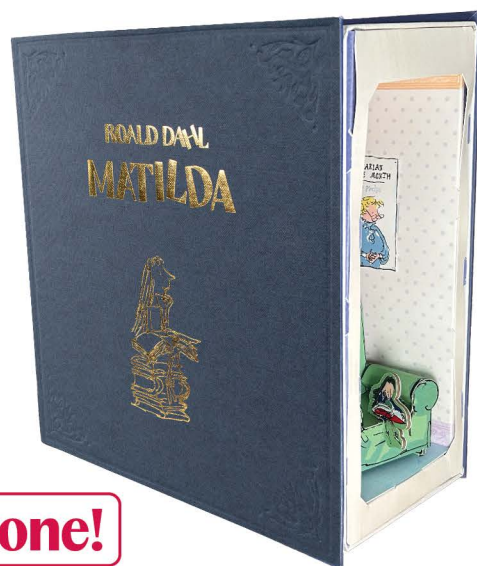

60



If you have a **battery powered** tealight, like the one pictured above, you can use it in your Book Nook as a light\*



Only use an **LED** tealight, paper and fire do not mix well!

\* Tealight not included in this kit

61



Remove the ceiling light from the Book Nook, and take out the lightbulb as shown so you're just left with the lampshade



62



63

Push the lampshade over the 'flame' until it **clicks** into place





# HELP!

If you get stuck building our kit or the dog has eaten a part, get in contact and we will do our best to help.

Go to  
**BuildYourOwnKits.com**

Email us

**support@buildyourownkits.com**

Or talk to a real person!

Phone us on 023 8062 5855

Scan here for  
quick access to our  
support page.



Find us on  
social media



## WANT MORE?

Head over to our website  
to see all our amazing kits.

**BuildYourOwnKits.com**



**WARNING!** Not suitable for children under 3 years due to small parts. Choking Hazard. Recommended age 8+. Retain these instructions for future reference.

© 2025 The Roald Dahl Story Company Ltd / Quentin Blake.  
ROALD DAHL is a registered trademark of The Roald Dahl Story Company Ltd | [www.roadddahl.com](http://www.roadddahl.com)

Paper Engine Ltd, MacLehose House, Unit A, Woodside Trade Centre, 34 Parham Drive, Eastleigh, Hampshire, SO50 4NU, UK  
EU Authorised Representative, Vulcan Consulting, 38/39 Fitzwilliam Square West, Dublin 2, D02 NX53, Ireland

© Paper Engine Ltd 2025 [www.paperengine.com](http://www.paperengine.com) Product Code: BYO BN 001 R1 Printed and manufactured in Heshan, China by Hung Hing Printing Group 07/2025