

30

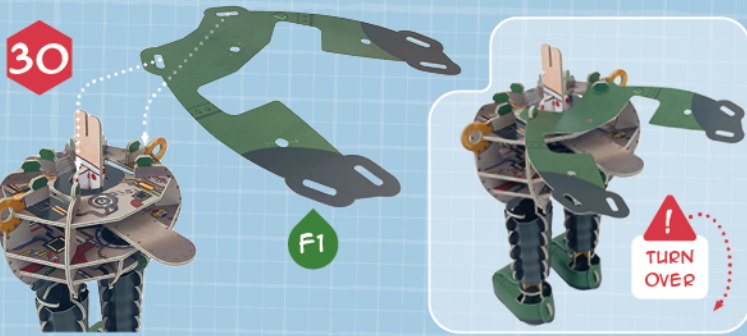

31

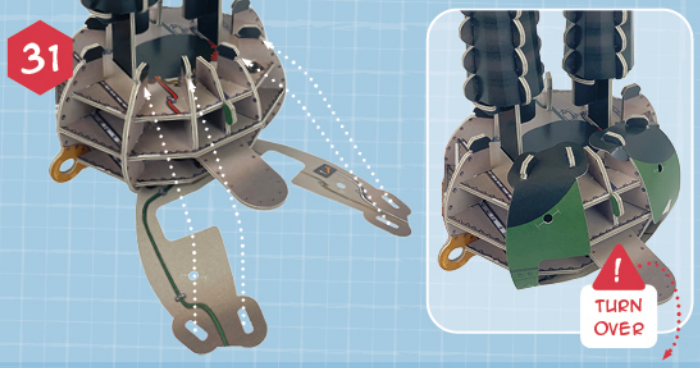

32

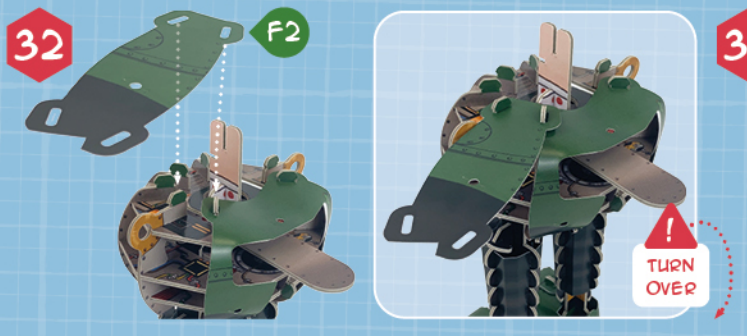

33

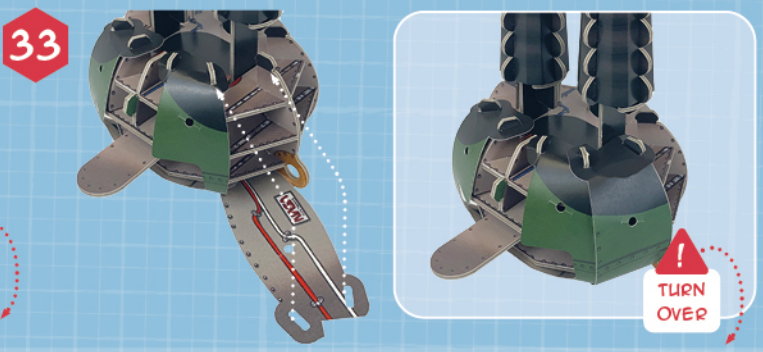

34

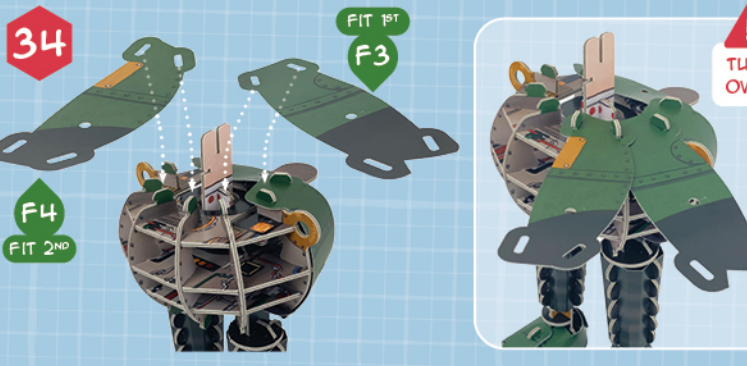

35

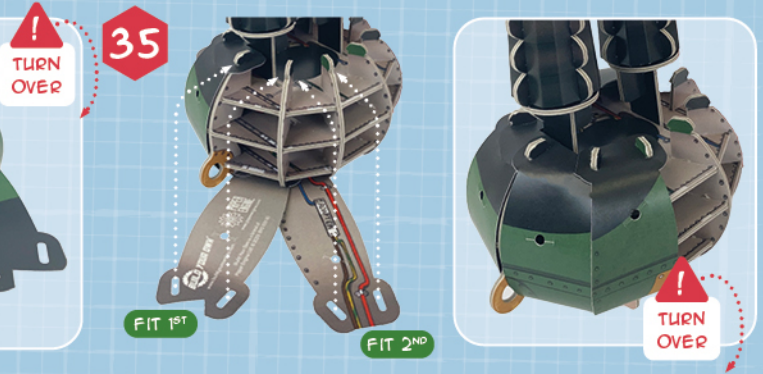

36

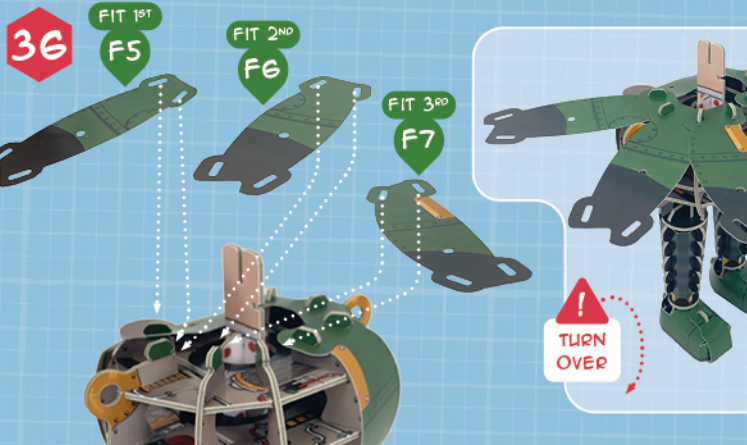

37

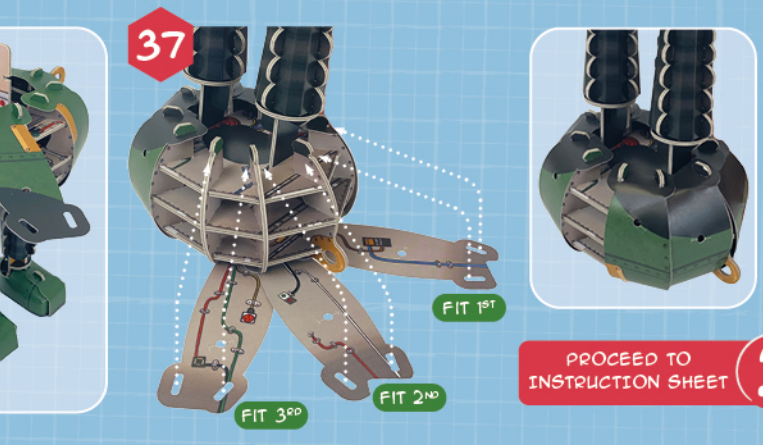

PAPER ENGINE LTD © 2023. © AND TM AARDMAN ANIMATIONS LIMITED/ WALLACE & GROMIT LIMITED 2023. ALL RIGHTS RESERVED.
PAPER ENGINE LTD, 49 LEIGH ROAD EASTLEIGH, HAMPSHIRE, SO50 9DF, UK. WWW.PAPERENGINE.COM. ITEM CODE: BYOMBOH-PI
PRINTED AND MANUFACTURED IN HESHAN, CHINA BY HUNG HING PRINTING GROUP 11/2022



INSTRUCTION SHEET

1

Recommended age 10+
WARNING! Not suitable for children under 3 years. Small parts. Choking Hazard.
DO NOT leave the kit unattended, especially with younger children who may not be familiar with the risks mentioned above.
Retain this packaging for future reference.

BEFORE YOU START

- 1 USE THE **REMOVAL TOOL** TO HELP PUSH OUT THE SMALLER BITS OF CARD. THERE ARE 2 REMOVAL TOOLS IN THIS KIT - USE THE SECOND TOOL IF THE FIRST BECOMES WORN.
- 2 IF YOU GET STUCK, LOOKING AT THE NEXT COUPLE OF STEPS COULD HELP YOU OUT.

- 3 PRE-CREASE ALL THE FOLDS **BEFORE** YOU BUILD EACH STEP UNLESS A STEP TELLS YOU OTHERWISE.
- 4 **DON'T RUSH!** MAKE YOURSELF A CUPPA AND TAKE YOUR TIME WHILE BUILDING. YOU WOULDN'T WANT TO DAMAGE YOUR KIT!

SCAN HERE FOR VIDEO INSTRUCTIONS AND LOADS MORE!



14



15

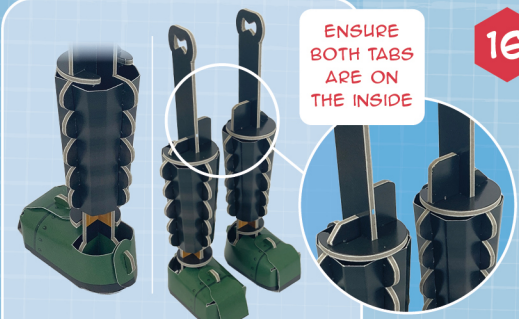

ENSURE
BOTH TABS
ARE ON THE
INSIDE

16

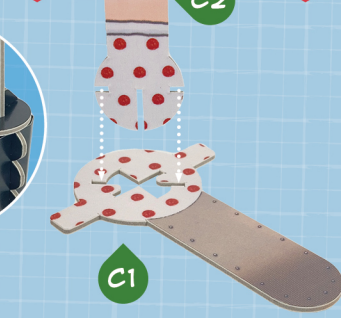

C2

C1

17



TURN
OVER

REPEAT STEPS 1 TO 15 FOR PARTS B1 TO B12
PUT BOTH LEGS TO ONE SIDE UNTIL STEP 19

18

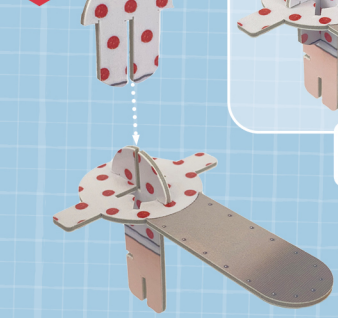

C3

TURN
OVER

PUT TO ONE SIDE
UNTIL STEP 21

19



D1

20

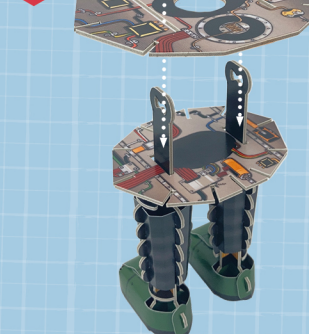

D2

21

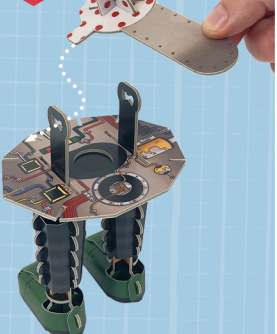

22

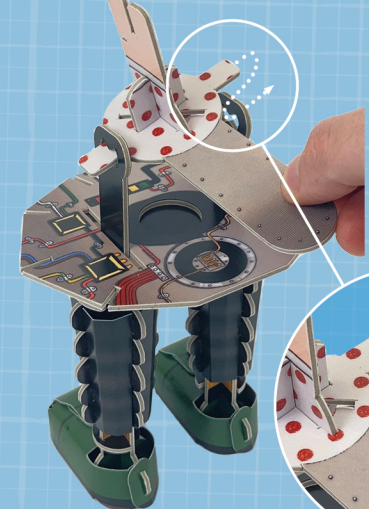

GENTLY FLEX
TO HELP WITH
FITTING

23

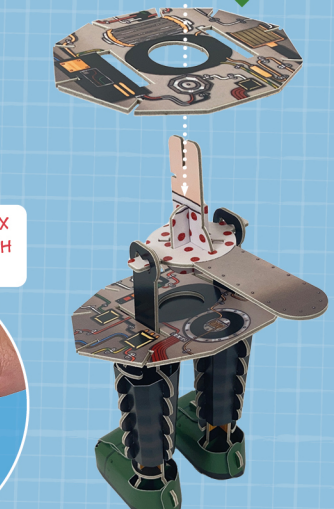

D3



"CRACKING
JOB
GROMIT!"



24

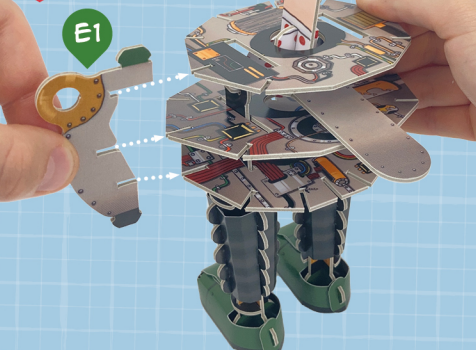

E1

25

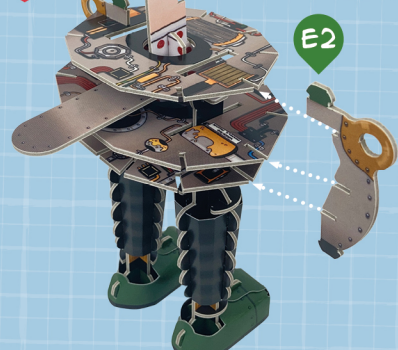

E2

MAKE SURE PARTS
ARE ALIGNED

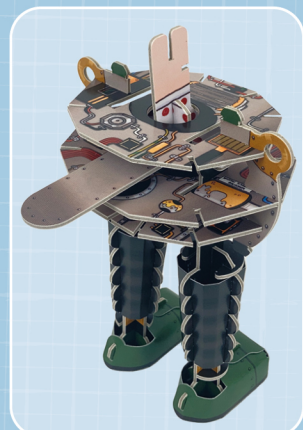
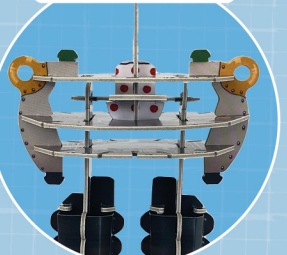

26

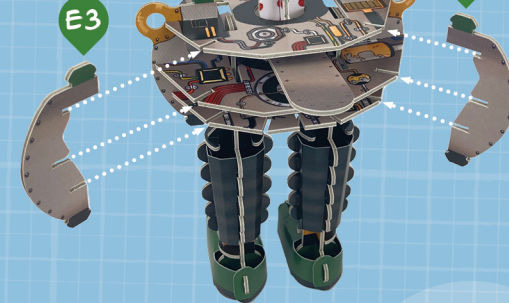

E3

E4

27

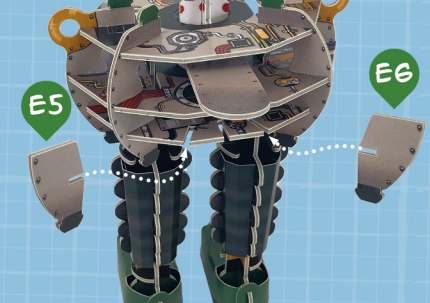

E5

E6

28

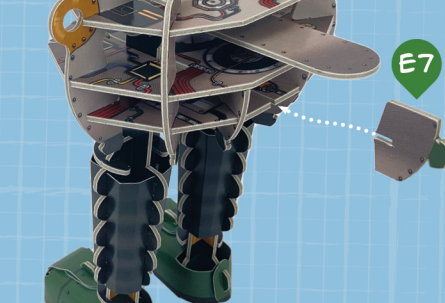

E7

29

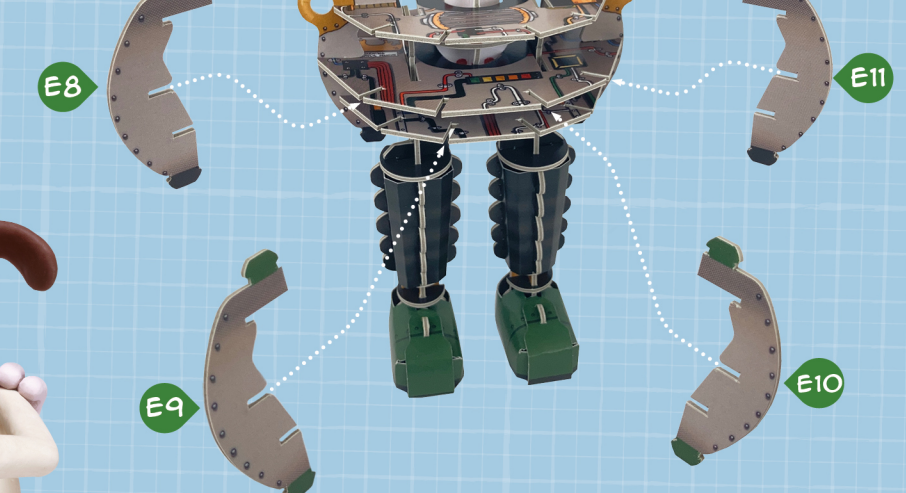

E8

E11

E9

E10

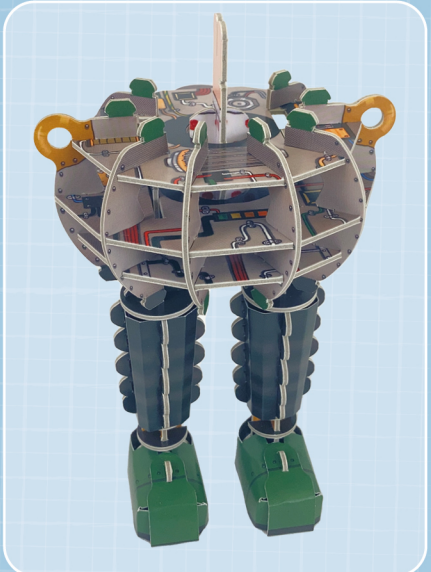

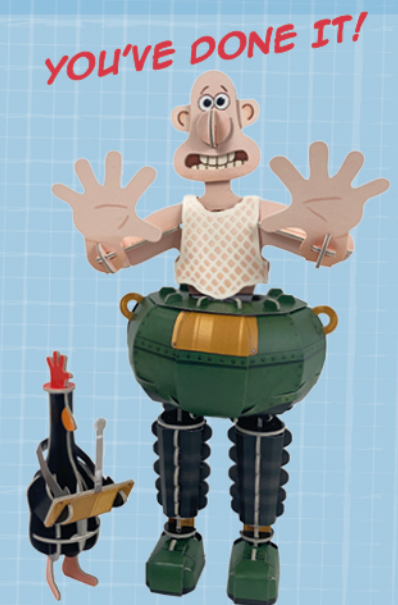
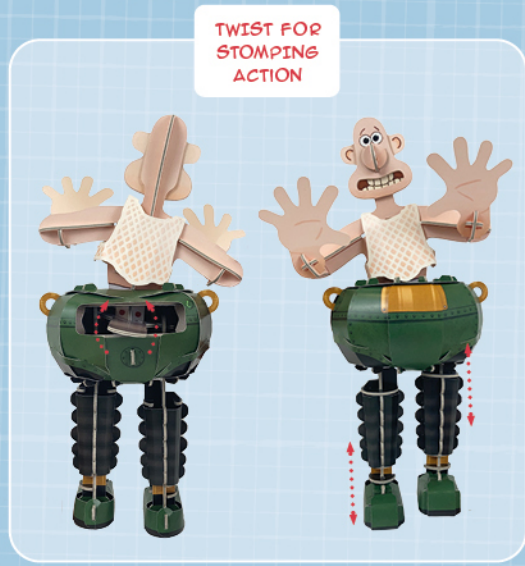
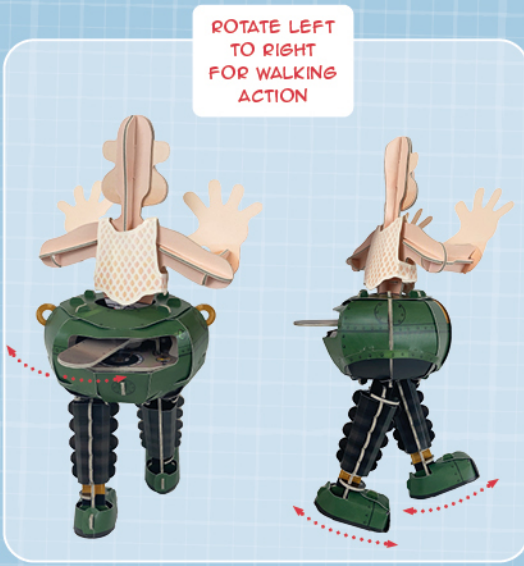
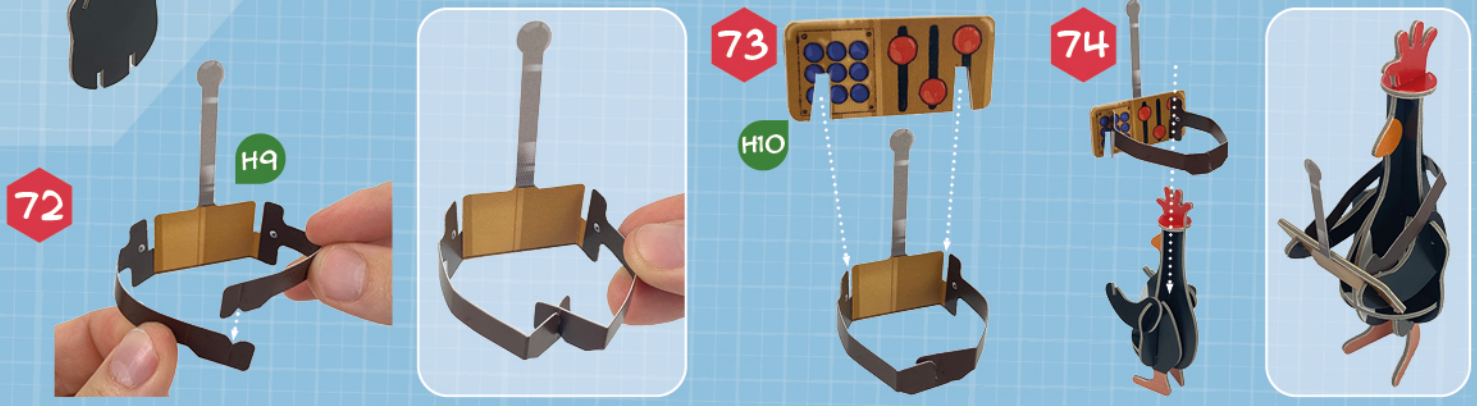
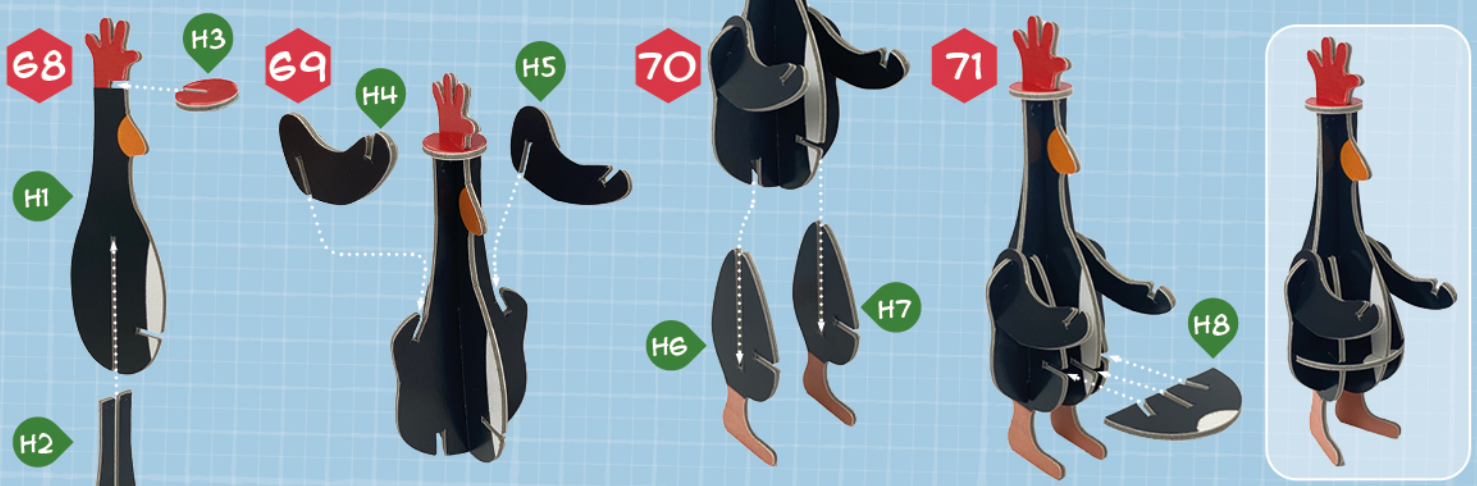

PAPER ENGINE LTD © 2023. © AND TM AARDMAN ANIMATIONS LIMITED/ WALLACE & GROMIT LIMITED 2023. ALL RIGHTS RESERVED.
 PAPER ENGINE LTD, 49 LEIGH ROAD EASTLEIGH, HAMPSHIRE, SO50 9DF, UK. WWW.PAPERENGINE.COM ITEM CODE: BYOMBOH-PI
 PRINTED AND MANUFACTURED IN HESHAN, CHINA BY HUNG HING PRINTING GROUP 11/2022

AARDMAN
Wallace & Gromit
Est. 1989

TECHNO TROUSERS

INSTRUCTION SHEET

2

Recommended age 10+

WARNING! Not suitable for children under 3 years. Small parts. Choking Hazard.

DO NOT leave the kit unattended, especially with younger children who may not be familiar with the risks mentioned above.

Retain this packaging for future reference.

38 39 40 F8 F9

REPEAT ON THE OTHER SIDE WITH F9

41 42 43 F10 F11

FOLD OVER THE SMALL TABS AND PUSH THROUGH THE SLOT, THEN UNFOLD AGAIN

TURN OVER

44 45 46 47 48 F12

GENTLY PULL OUT BOTH PANELS SO THEY SIT ON THE OUTSIDE

