

26

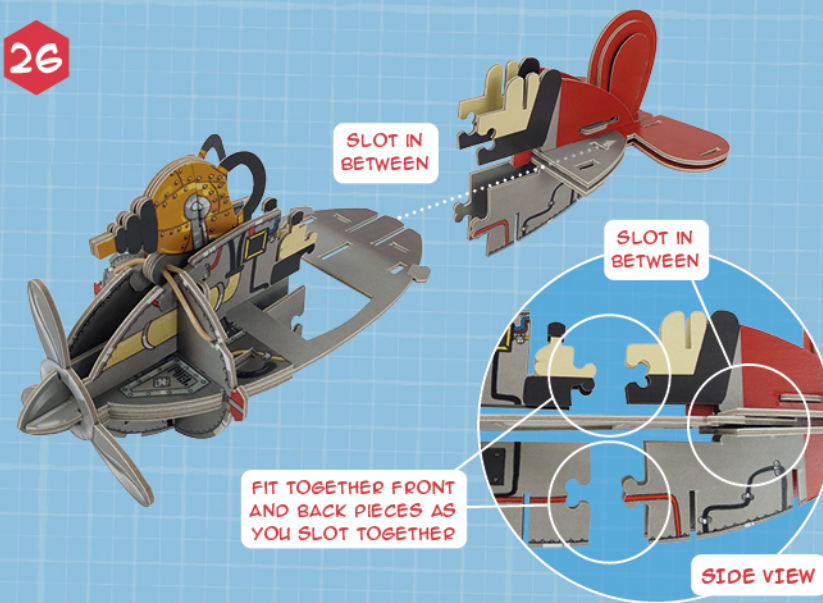

SIDE VIEW

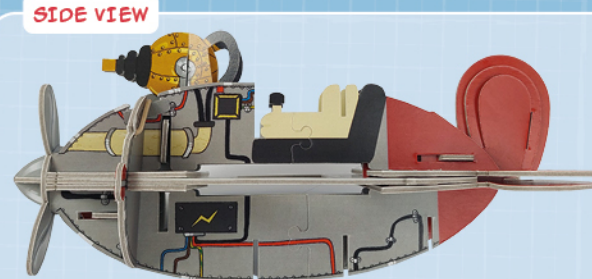

TOP VIEW

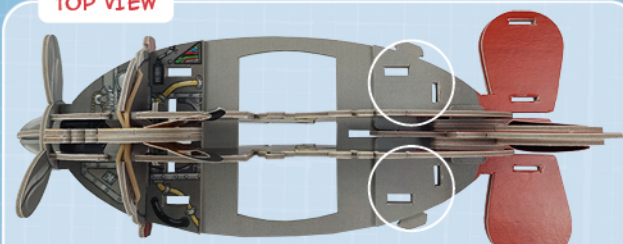

ENSURE ALL THE SLOTS  
ARE LINED UP

27

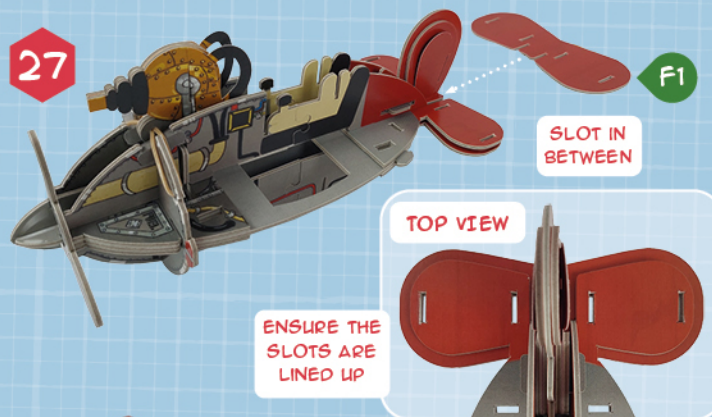

28



29



30



31



32

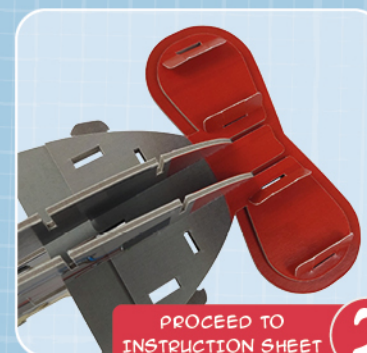

PROCEED TO  
INSTRUCTION SHEET

2

AARDMAN



Wallace & Gromit  
Est. 1989  
SIDECAR PLANE

BEFORE YOU START

- 1 USE THE REMOVAL TOOL TO HELP PUSH OUT THE SMALLER BITS OF CARD.
- 2 IF YOU GET STUCK, LOOK AT THE NEXT FEW STEPS.
- 3 THE ELASTIC BANDS ARE ON ONE OF THE THIN SHEETS, INCLUDING 1 SPARE.



- 4 PRE-CREASE ALL THE FOLDS BEFORE YOU BUILD EACH STEP UNLESS A STEP TELLS YOU OTHERWISE.

- 5 DON'T RUSH! MAKE YOURSELF A CUPPA AND TAKE YOUR TIME WHILE BUILDING. YOU WOULDN'T WANT TO DAMAGE YOUR KIT!

SCAN HERE FOR  
VIDEO INSTRUCTIONS  
AND LOADS MORE!



1



A2

FOLD PART A2  
IN HALF FIRST

2



3



PUSH UNTIL  
A3 CLICKS  
INTO PLACE

4



5



A6

PUT TO ONE SIDE  
UNTIL STEP 11



6



B1

B2

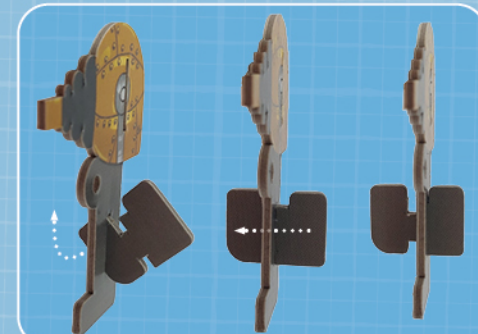

7

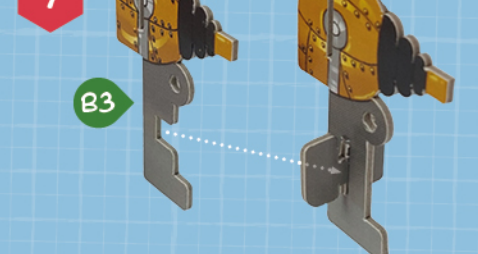

B3

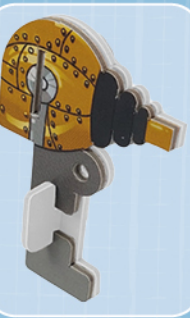

8

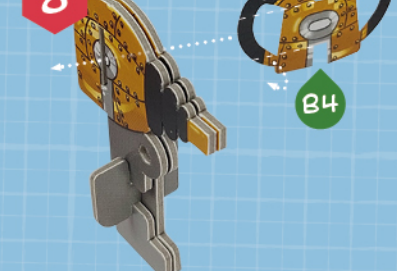

B4

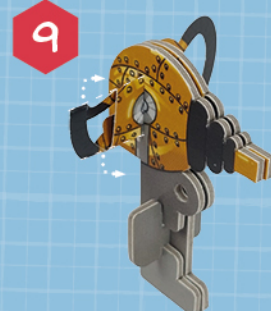

10

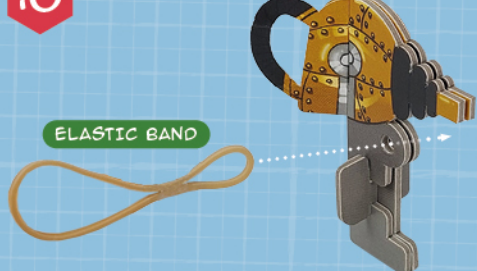

ELASTIC BAND

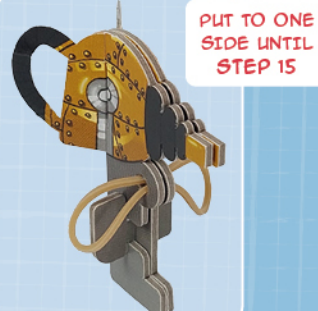

PUT TO ONE  
SIDE UNTIL  
STEP 15



11

C2

C1

12

C3

ENSURE C3 IS PUSHED IN FULLY AS SHOWN

TOP VIEW

13

C4

SLOT C4 ON TOP

C5

SLOT C5 UNDERNEATH

SIDE VIEW

C4

C5

TOP VIEW

C4

C5

ENSURE C4 AND C5 ARE PUSHED IN FULLY AS SHOWN

14

C7

C6

LINE UP THE SLOTS

15

GENTLY FLEX OUT SIDES TO HELP GUN SLOT IN

16

C9

C8

ENSURE TAB CLICKS INTO SLOTS BOTH SIDES

17

18

D1

D2

19

D4

D3

20

D5

21

22

23

D7

D6

SIDE VIEW

24

E2

E1

25

E3

E4

TOP VIEW

ENSURE E3 AND E4 ARE PUSHED IN FULLY AS SHOWN

SIDE VIEW

E3

E4

PULL UP TAIL TO HELP SLOT E3 AND E4 PAST TAB

"CRACKING JOB GROMIT!"

TOP VIEW

SIDE VIEW



56



57

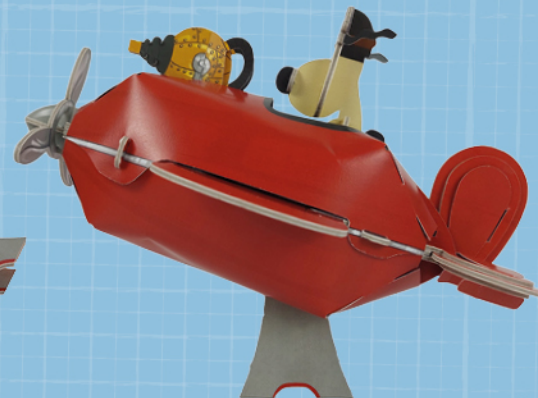
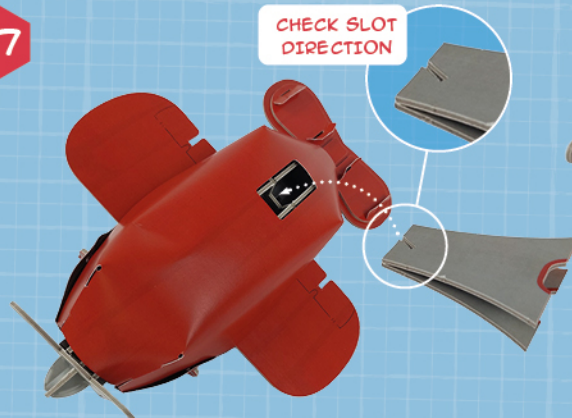

YOU'VE DONE IT!

### PORRIDGE CANNON

1

ENSURE THE  
PROPELLOR IS  
PULLED OUT FULLY

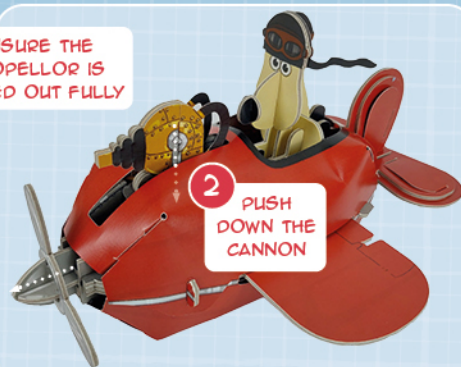

2

PUSH  
DOWN THE  
CANNON



3

HOLD DOWN  
THE CANNON  
AS YOU  
PUSH IN THE  
PROPELLOR  
TO LOCK

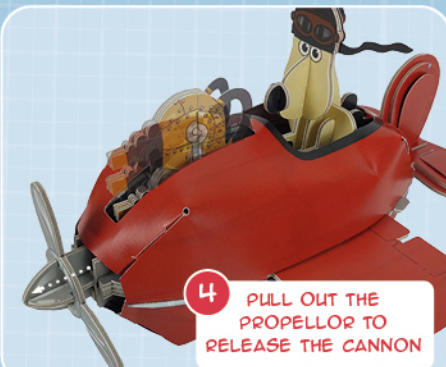

4

PULL OUT THE  
PROPELLOR TO  
RELEASE THE CANNON

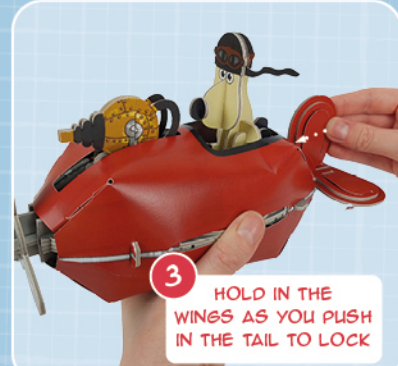

### WINGS

1

ENSURE THE TAIL IS  
PULLED OUT FULLY

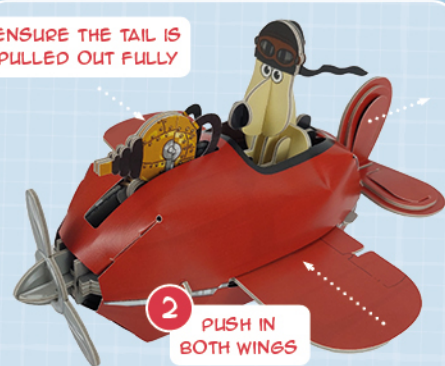

2

PUSH IN  
BOTH WINGS

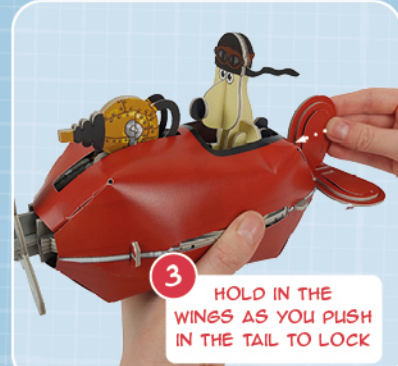

3

HOLD IN THE  
WINGS AS YOU  
PUSH IN THE  
TAIL TO LOCK

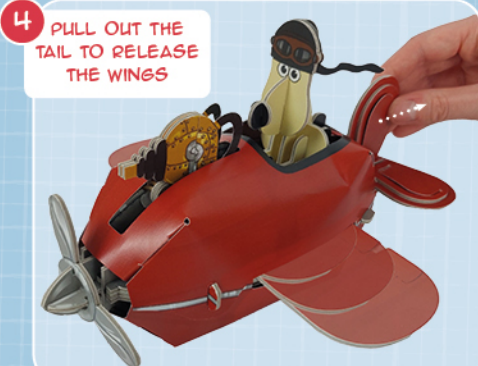

4

PULL OUT THE  
TAIL TO RELEASE  
THE WINGS

33

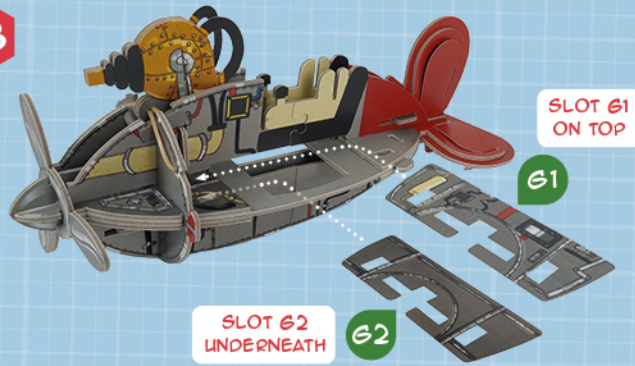

SLOT 61  
ON TOP

61

SLOT 62  
UNDERNEATH

62

34

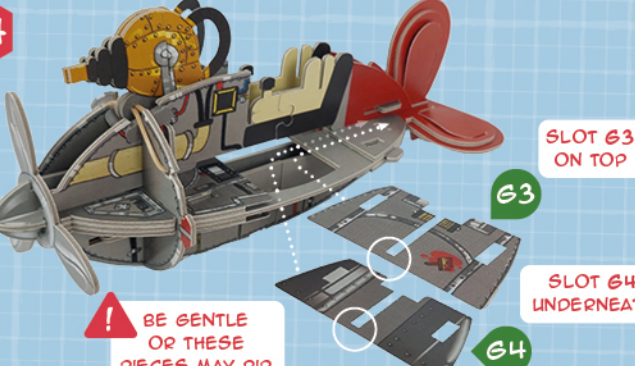

SLOT 63  
ON TOP

63

SLOT 64  
UNDERNEATH

64

BE GENTLE  
OR THESE  
PIECES MAY RIP

SIDE VIEW - FRONT

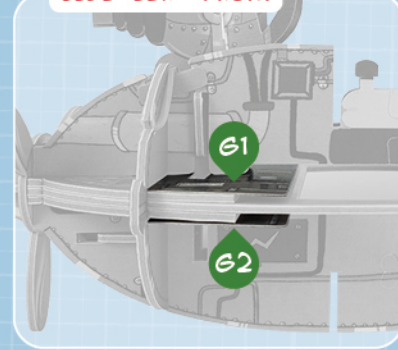

61

62

SIDE VIEW - BACK



63

64

ENSURE ALL THE SLOTS  
ARE LINED UP

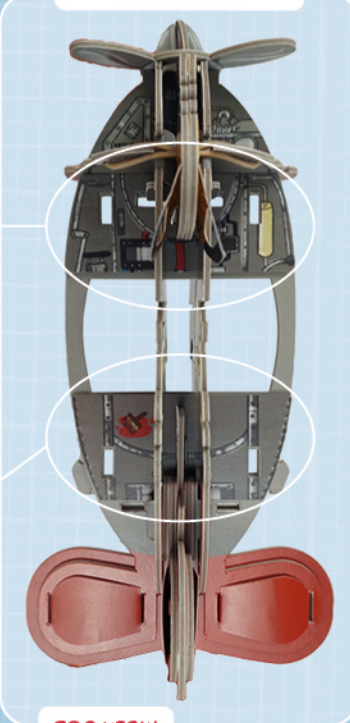

TOP VIEW

35



65

36



66

37

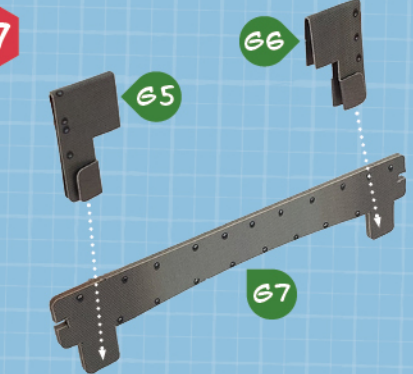

65

66

67

REPEAT STEPS  
35-36 FOR  
PART 66

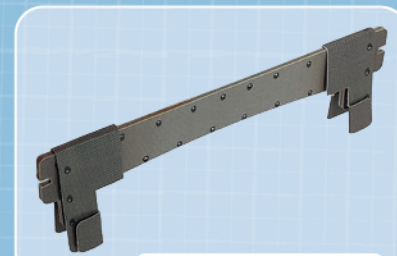

HOLD IN PLACE READY  
FOR NEXT STEPS

AARDMAN



Wallace & Gromit  
Est. 1989  
SIDECAR PLANE

INSTRUCTION  
SHEET

2

Recommended age 10+  
**WARNING!** Not suitable for children under 3 years.  
Small parts. Choking Hazard.  
**WARNING!** Use only when stationary to prevent trips or falls.  
**DO NOT** leave the kit unattended, especially with younger  
children who may not be familiar with the risks mentioned above.  
**WARNING!** Rubber bands may contain latex.  
Retain these instructions for future reference.



38

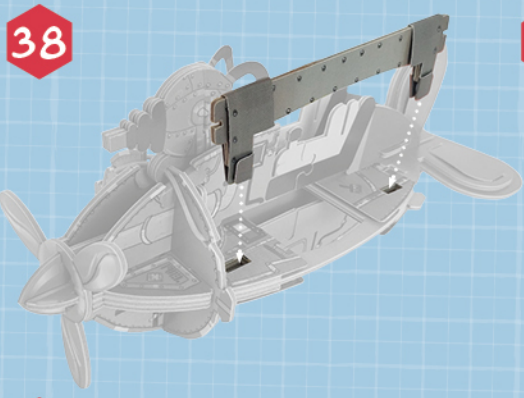

39

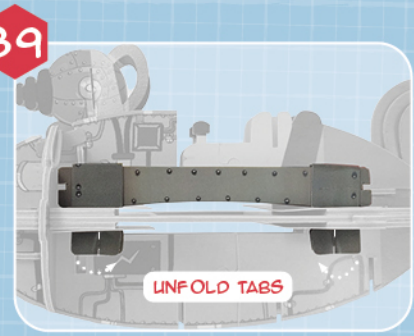

40

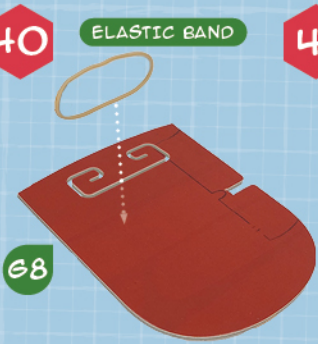

41

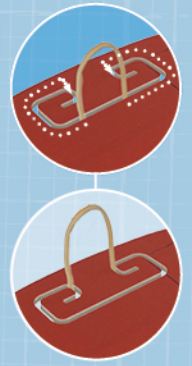

42

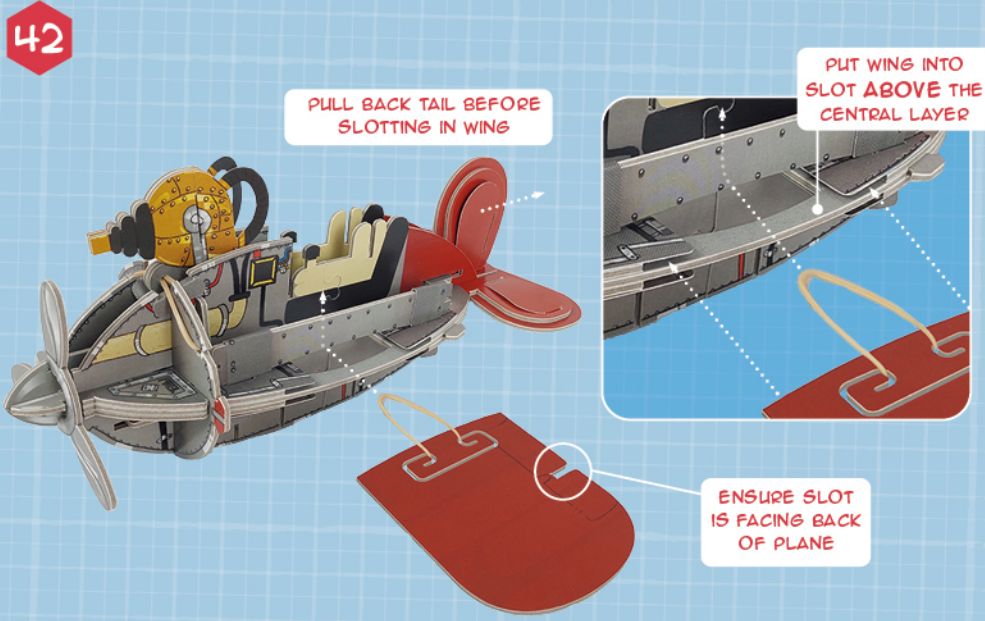

43

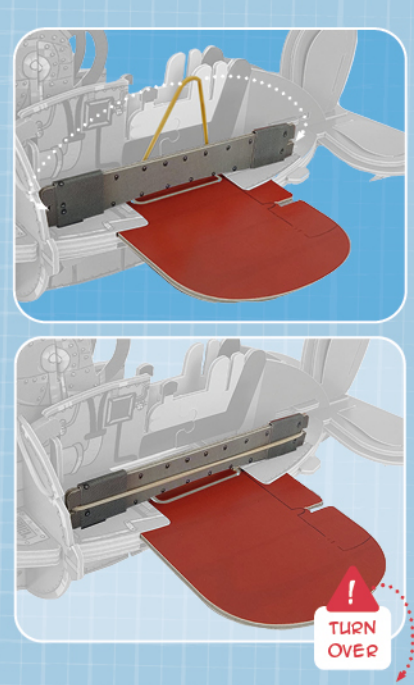

44

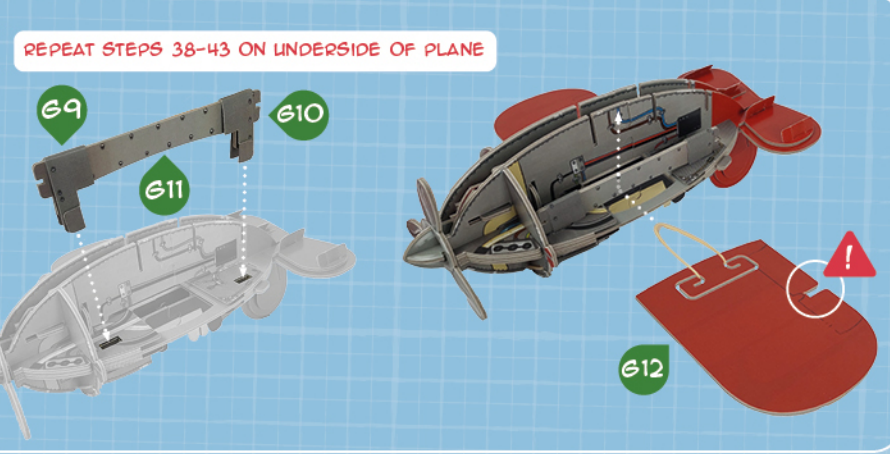

45

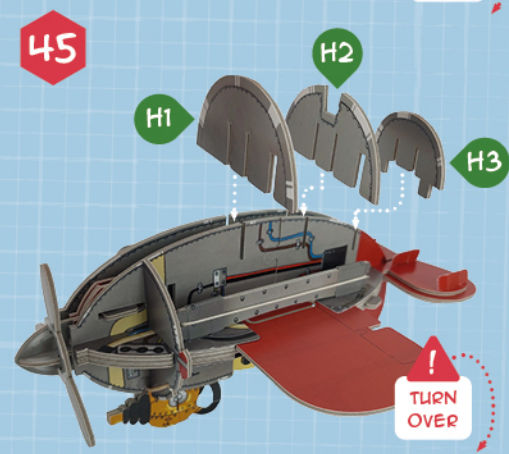

46

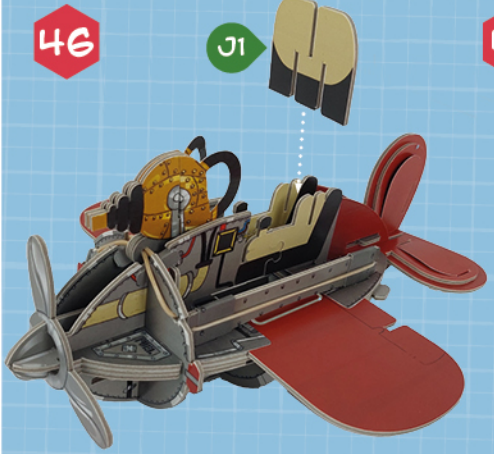

47

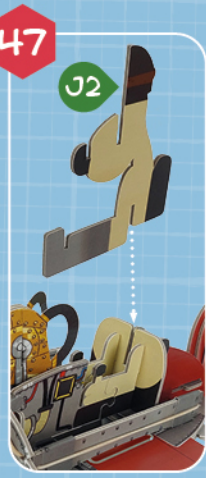

48



49

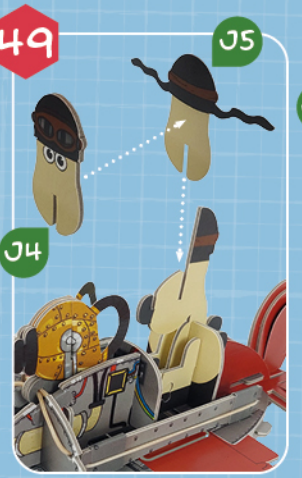

50

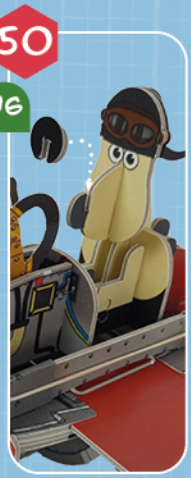

51

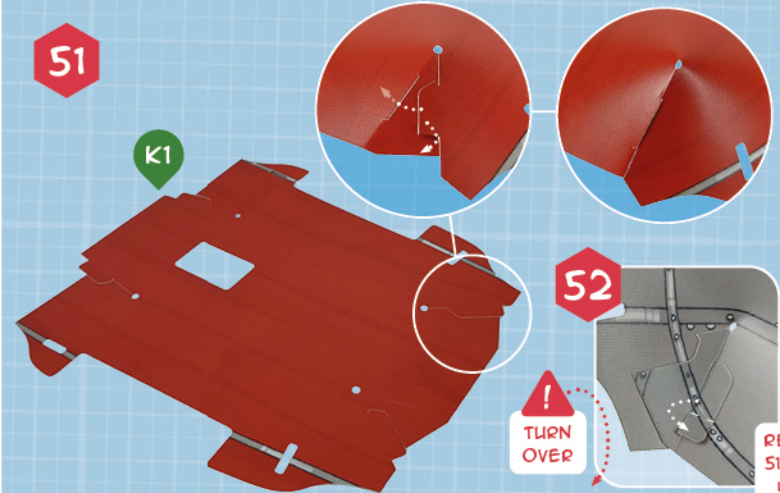

53



54

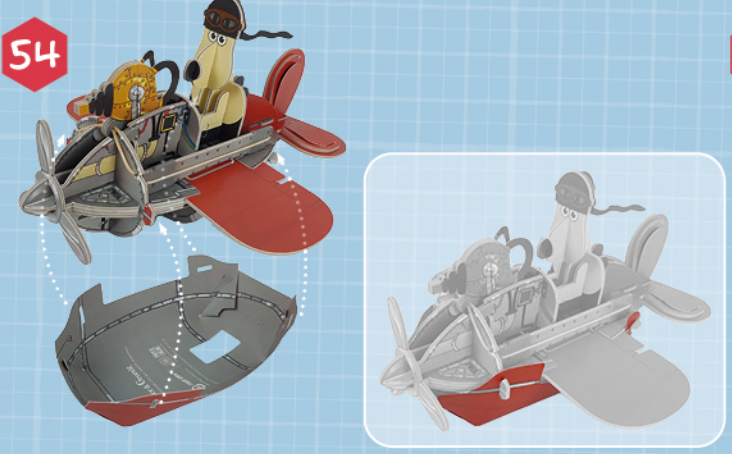

55

