

HOW TO USE

To use the telescope, rest the base on a flat, stable surface such as a table. Put your eye over the eyepiece and angle the tube towards your target, slowly moving the outer tube in and out to adjust the focus.

VIEWING ANGLE

Change the angle of the telescope by moving the adjustable leg along the grooved base.

FOCUSING

Slide the tube towards the tree symbol to focus on objects nearby, or the moon symbol for objects further away. See the **'Focusing Tips'** leaflet for more tips and tricks.

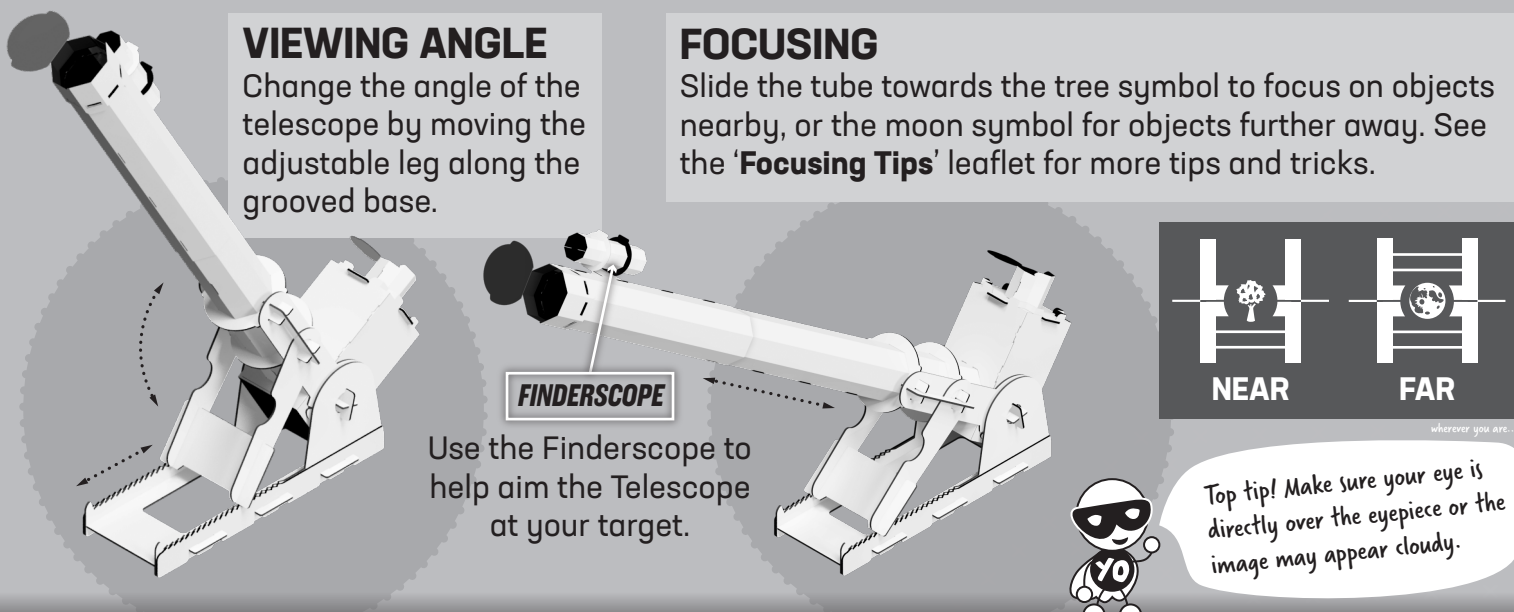

WARNING:
NEVER POINT
THE TELESCOPE
AT THE SUN OR
BRIGHT LIGHTS

WHY IS THE IMAGE MIRRORED?
Did you notice that the objects you are looking at are back to front? Due to the configuration of the lenses, the image is flipped as it travels through the telescope.

$$\frac{\text{Objective focal length}}{\text{Eyepiece focal length}} = \frac{671.5\text{mm}}{41.2\text{mm}} =$$

16.3x MAGNIFICATION

BUILD YOUR OWN TELESCOPE

BEFORE YOU START

The mirror and two lenses are in the brown envelope in the top pocket of the outer box!



Yo! Use the removal tool to help push out the smaller bits of card!

MIRROR

Please note there are TWO protective films on the mirror. Carefully remove the blue film and the clear film underneath when you're ready to build the Telescope.

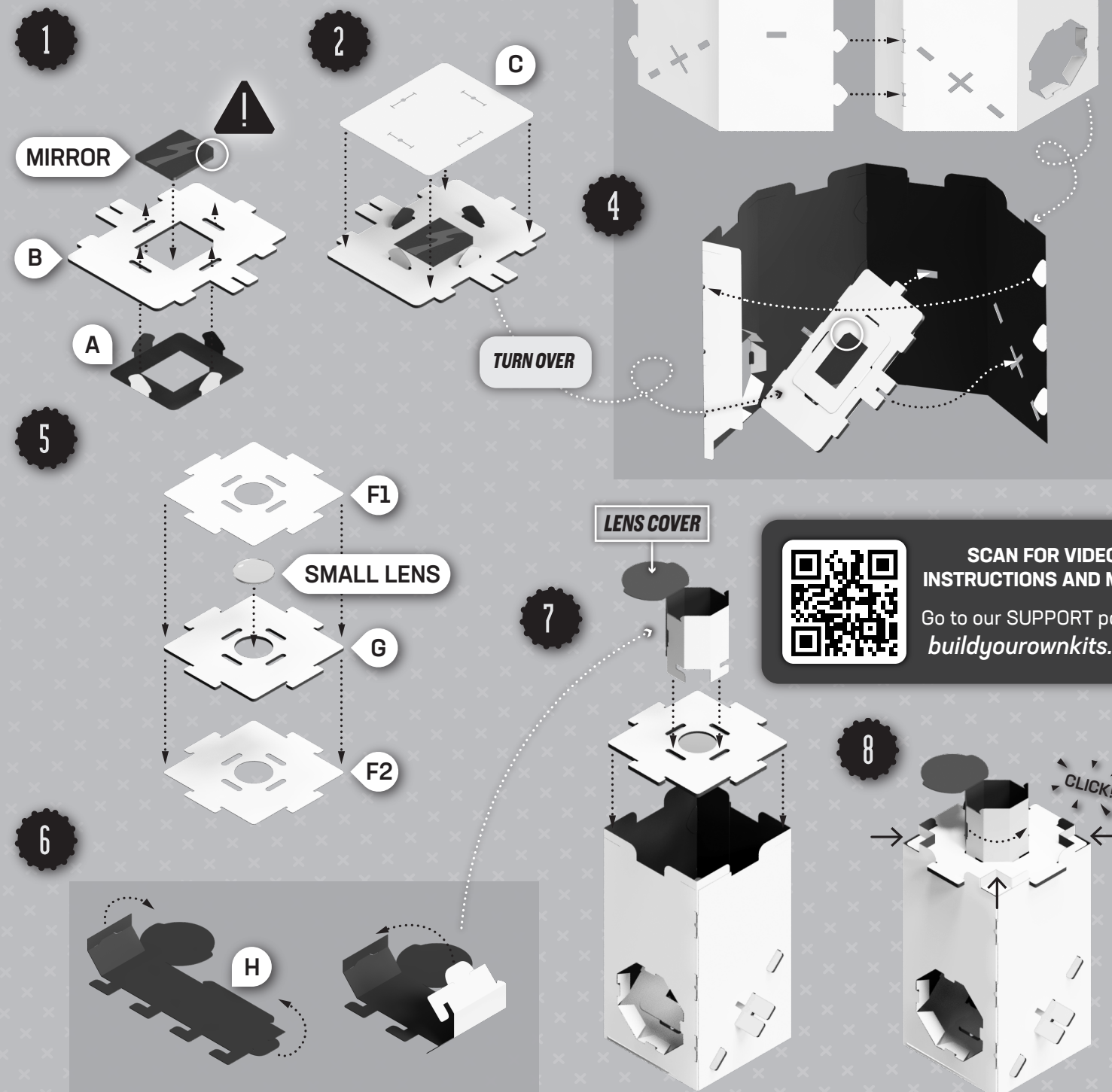

WARNING!

- Use only under adult supervision and/or guidance - Only to be used by persons capable of understanding the safety aspects concerning misuse of the product.
- DO NOT look directly at the sun with the naked eye or with this telescope. Permanent and irreversible eye damage may occur.
- DO NOT use the telescope to project an image of the sun onto any surface. This can present a severe fire risk.
- DO NOT leave the telescope unattended, especially with children or adults who may not be familiar with the risks mentioned above.
- DO NOT store in places where direct sunlight may enter the lenses. Always cover any lenses with the protective caps when not in use.
- Check product regularly for signs of damage or breakage (e.g. glass elements) and if found discontinue use.
- Take care when placing eye over eyepiece

